



# **Student Information Booklet 2025**



## **Bossley Park High School**



FOCUSING on EXCELLENCE and SUCCESS



Education



## Table of Contents

School Song .....	3
School Information.....	4
Principal's Message.....	5
About Our School .....	6
Bell Times 2025.....	7
Meet our Senior Executive Team .....	8
Executive Team .....	9
Year Advisers .....	11
Student Wellbeing .....	14
Your Mental Health Matters!.....	15
School Support Teams .....	16
Student Representative Council (SRC).....	17
House System .....	18
Interact Club .....	19
Staff List 2025.....	20
Important Uniform Requirements .....	21
School Uniform Code and Procedures.....	21
Attendance .....	24
High Potential and Gifted Education .....	26
Talented Football Program .....	29
Robotics Club .....	30
Bring Your Own Device (Senior's).....	31
Core Rules.....	32
Core Values .....	33
School Safety .....	34
Mobile Phone Policy .....	35
Merit Awards.....	36
PBL Reward System .....	38
School Library.....	39
Agriculture.....	40
Disability Support Unit .....	41
Careers Department .....	42
Curriculum .....	44
Charges & Administration Costs .....	46
Canteen Menu .....	47
School Bytes: Parent Portal.....	49
School Map.....	54
Parent and Carer Information .....	55
Frequently Asked Questions .....	56
Saturday School .....	59





# School Song

## Verse 1

We are a school called Bossley Park High,  
Where we learn and where we strive;  
With our teachers to do our best,  
Focusing on excellence and success.

## Chorus

Goodness is symbolised through  
Our black and white colours.  
We're always there to lend a hand to others.  
Multicultural races harmonise to fill the halls;  
So it's plain to see the place to be,  
Is behind our Bossley walls.

## Verse 2

Teachers and students working as one,  
Through years of achievement,  
To get things done;  
In an environment of prosperity,  
Bossley Park is the place to be.

## Go Back to Chorus



*Sports Centre*



FOCUSING on EXCELLENCE and SUCCESS



Education



# School Information

## Contact Details

Address: 36-44 Prairie Vale Road Bossley Park NSW 2176

Phone: (02) 9823 1033 Fax: (02) 9823 7835

Email: [bossleypk-h.school@det.nsw.edu.au](mailto:bossleypk-h.school@det.nsw.edu.au)

Website: <https://bossleypk-h.schools.nsw.gov.au>

Facebook: BPHS Wellbeing

Twitter (X): bossleyparkhs

Instagram: bossleyparkhs

Office Hours: 8:05AM – 3:15PM (**Sales close at 2PM**)

Parent/Student Portal: <https://bossleyparkhs.sentral.com.au/portal/>

## Rel. Director Public Schools NSW – Cowpasture Network

Jason Conroy – Campbelltown Education Office – (02) 4663 2700

## Community Support Group (CSG)

CSG Meetings are held at Club Marconi upstairs conference room at 6PM, typically on a Monday. Parents will remember the P&C at their previous primary schools. We refer to it as the CSG. Dates and times are confirmed via email and school website updates to parents. Please look out for correspondence relating to CSG meetings throughout the year.

All parents are welcome to attend.

## Bus Information

Transit Systems – (02) 8778 5800 or [www.transitsystems.com.au](http://www.transitsystems.com.au)



*First Nations Mural Opening Ceremony 2024*



# Principal's Message

## ***Welcome to Bossley Park High School***

Bossley High Park School offers a wide range of teaching and learning programs. Our comprehensive curriculum provides many opportunities for all students to engage and thrive in a diverse learning experience. At Bossley Park High School, we aim to have students build positive connections within the school community and make them feel known, valued, and cared for.

The school is recognised for its comprehensive curriculum including high potential and gifted programs. Extensive extra-curricular activities allow students to excel in sporting and cultural pursuits and opportunities for participation and development in leadership are provided.

Bossley Park High School fosters a culture of high expectations for staff and students. We are committed to ensuring students are Safe, Respectful Learners and maintain correct uniform standards. A key focus area of this is to unearth student talent and develop their potential.

The school provides alternate educational opportunities that are offered by TAFE, school-based apprenticeships and traineeships, and community agencies to provide a variety of educational pathways that cater for individual needs and aspirations. An important feature of our school is the support that is offered to each child, with special programs addressing the learning requirements of students with specific needs.

At Bossley Park High School, we promote that all students have a right to learn and a responsibility to learn. We are a 'Positive Behaviours for Learning' school and promote this as a foundation block in our school culture. We are well known in the community for our strong wellbeing initiatives and comprehensive discipline policy which support all students in their development as an individual and as a student, so their potential is realised.

We have a strong commitment to maintaining an attractive school environment and providing excellent facilities. We promote and have maintained strong community support with parents playing an active and supportive role in the school.

To ensure high-quality teaching and learning and improved student outcomes at Bossley Park High School, we are committed to the ongoing professional development of all staff. We value and foster staff morale and cohesion by acknowledging and valuing the work of all staff, their commitment and achievements.

Through high-quality teaching and learning programs, a comprehensive discipline policy, and wellbeing initiatives that promote student leadership, resilience, and responsibility for learning, we aim to develop students who can confidently meet the challenges of the future and take their place as responsible citizens.

Mr Chris Hollis  
***Principal***

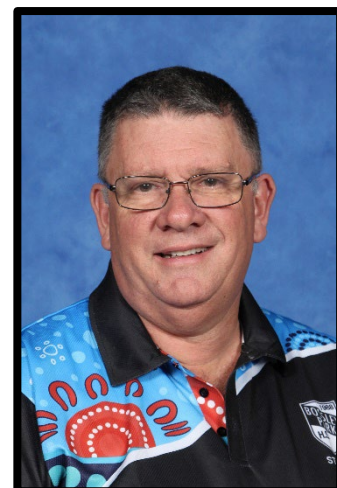



# About Our School

Bossley Park High School is built on land that was formerly farm lets, producing vegetables, flowers and poultry products.

The first student intake of the school entered Year 7 on 2 February 1988. Our students are largely drawn from the neighbouring primary schools in our network – Governor Philip King Public School, Bossley Park Public School, Prairie Vale Public School and Edensor Park Public School. Amongst our enrolment are some students with diverse learning leads.

The school colours are black and white. The crest was designed in 1987 by Mr Lance Hopper, a Visual Arts teacher at Grantham High School. The school flag was designed in 1991 by one of our Year 8 students, Cynthia Scuito. Our school song was composed by a Year 8 student Belinda Crozzolii in 1994 who went on to become a Music teacher.

Each student belongs to a House group. The House groupings are mainly for student roll, though there is a House sporting competition. The four Houses are Edina (green), Gandangara (yellow), Sartor (red) and Tarburton (blue).



*Aerial photo of Bossley Park High School (November 2024)*



FOCUSING on EXCELLENCE and SUCCESS



Education



# Bell Times 2025

## ALL Years 7-12

PERIOD	MONDAY (LATE START)	TUESDAY, WEDNESDAY, THURSDAY, FRIDAY
Warning	9.17am	8.37am
ROLL CALL	9:20am	8:40am
1	9.30am	8.50am
RECESS 1	10.10am	10.10am
2	10.25am	10.25am
RECESS 2	11.45am	11.45am
3	12:00pm	12.00pm
LUNCH 1	1.15pm	1.15pm
LUNCH 2	1.30pm	1.30pm
4	1.45pm	1.45pm
END OF SCHOOL DAY	3.00pm	3.00pm

**Evacuation:** It is an emergency if there is a **CONTINUOUS** ringing of the bell. If this occurs, the building must be evacuated **IMMEDIATELY**.  
Staff and students are required to move quickly but safely to the **SCHOOL OVAL**.

**Lockdown:** Is signalled by 10 or more consecutive rings of the bell.  
Classes remain in place. Check corridor and have unsupervised students enter. Mark roll then conduct lesson until further notice or all clear.

### 2025 School Dates for Students

Term 1 – Thursday 6<sup>th</sup> February 2025 – Friday 11<sup>th</sup> April 2025

Term 2 – Wednesday 30<sup>th</sup> April 2025 – Friday 4<sup>th</sup> July 2025

Term 3 – Tuesday 22<sup>nd</sup> July 2025 – Friday 26<sup>th</sup> September 2025

Term 4 – Tuesday 14<sup>th</sup> October 2025 – Friday 19<sup>th</sup> December 2025





# Meet our Senior Executive Team

**Principal**  
Mr C Hollis



**Deputy Principal**  
Mr T Panagiotakis  
Yr 9/12



**Deputy Principal**  
Ms J Villanueva  
Yr 7/10



**Rel. Deputy Principal**  
Ms K Curic  
Yr 8/11





# Executive Team

**Business Manager**  
Ms A Liori



**School Administrative Manager**  
Ms L Zappia



**Head Teacher Administration**  
Mr P Riddle



**Rel. Head Teacher Administration**  
Ms J Dundovic



**Head Teacher Secondary Studies**  
Ms A Chehade



**Head Teacher Wellbeing**  
Mr N Zantiras



**Head Teacher Home Economics**  
Ms M Lopez



**Head Teacher Learning Support**  
Ms L Roby



**Head Teacher Teaching & Learning**  
Mr L Vacarro



**Head Teacher Teaching & Learning**  
Ms K Simic



**Rel. Head Teacher Teaching & Learning**  
Ms A Matic



**Rel. Head Teacher Teaching & Learning**  
Ms L Jane



FOCUSING on EXCELLENCE and SUCCESS



Education



# Executive Team

**Head Teacher  
English**  
Ms N Faul



**Head Teacher  
Mathematics**  
Ms S Sampol



**Head Teacher  
Science**  
Ms S Pham



**Rel. Head Teacher  
History/LOTE**  
Mr B Clark



**Head Teacher  
Social Science**  
Mr J Frech



**Rel. Head Teacher  
Visual Arts**  
Ms Z Iaali



**Head Teacher  
Industrial Arts**  
Mr G Agostino



**Head Teacher  
Performing Arts**  
Ms M Lopez



**Head Teacher  
Disability Support Unit**  
Mr S Viravong

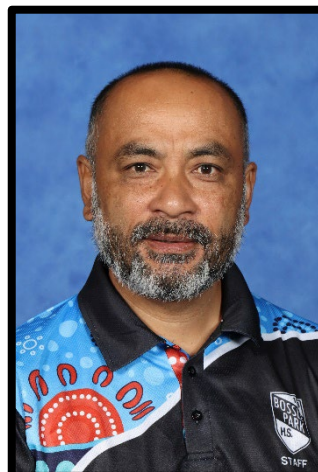

**Head Teacher  
PDHPE**  
Mr D Gaziler

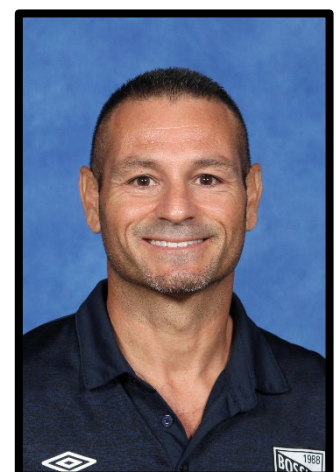



# Year Advisers

## Year 7 Advisers 2025



Ms A Pabiona  
**ENGLISH**



Mr M Medcalf  
**INDUSTRIAL ARTS**



## Year 8 Advisers 2025



Ms L Armstrong  
**LEARNING SUPPORT**



Ms G Lee  
**MATHEMATICS**



FOCUSING on EXCELLENCE and SUCCESS



Education



# Year Advisers

## Year 9 Advisers 2025



Ms J Zeaiter  
**ENGLISH**



Mr J Lepore  
**PDHPE**



## Year 10 Advisers 2025



Ms S Tarar  
**VISUAL ARTS**



Ms L Tran  
**ENGLISH**



FOCUSING on EXCELLENCE and SUCCESS



Education



# Year Advisers

## Year 11 Advisers 2025



Ms E Ulbrand  
**PERFORMING ARTS**



Mr C Maia  
**ENGLISH**



## Year 12 Advisers 2025



Ms F Weir  
**LIBRARIAN**



Mr J Bian  
**LEARNING SUPPORT**



FOCUSING on EXCELLENCE and SUCCESS



Education



# Student Wellbeing

## The role of the Wellbeing Team

- Supporting the wellbeing of students at Bossley Park High School
- Seeking solutions to wellbeing problems, both general and individual
- Referring wellbeing problems to specialist services or agencies, where appropriate
- Reviewing, writing and implementing wellbeing policies
- Ongoing evaluation of policies and procedures
- Communicating with and providing guidance for staff
- Maintaining consistency throughout the school
- Initiating and coordinating staff development in wellbeing strategies and procedures
- Communicating with parents regarding wellbeing issues
- Monitoring student progress through semester reports, progress reports and the online system
- Coordinating activities and implementing programs to support the wellbeing needs of students.
- Meeting fortnightly to facilitate the above

**Head Teacher  
Wellbeing**  
Mr N Zantiras



## **The role of the Counsellors and Student Support Officers**

School Counsellors are employed by the Department of Education to assist students with a variety of educational, social and emotional issues. They can provide several services, including individual psychological assessments, counselling, educational assessments and assistance for students with special needs. School Counsellors work closely with the School Executive, Student Advisers, Careers Adviser, the Learning Support Team and other staff to help individual students achieve their goals. They also provide a link between feeder primary schools and Bossley Park High School, enabling a smoother transition into high school for many Year 7 students.

Our school counsellors are Ms Julianne Dimaano and Ms Shirley Lu. Ms Dimaano is available Tuesdays/Thursdays and Ms Lu is available Monday (Wk A)/Wednesday/Friday. The counsellor's office is located above the school library in A Block.

Students needing support out of school hours should call the Kids Helpline 1800 55 1800 or Lifeline 13 11 14.

Student Support Officers (SSO) work within the school community in partnership with the learning and support team and school counselling service to enhance student social and emotional wellbeing and learning outcomes. SSO provide both whole-of-school wellbeing initiatives and targeted strength based supports for students requiring personalised assistance. They also have a pivotal role in working collaboratively with external child and family support agencies and other government agencies to support students.

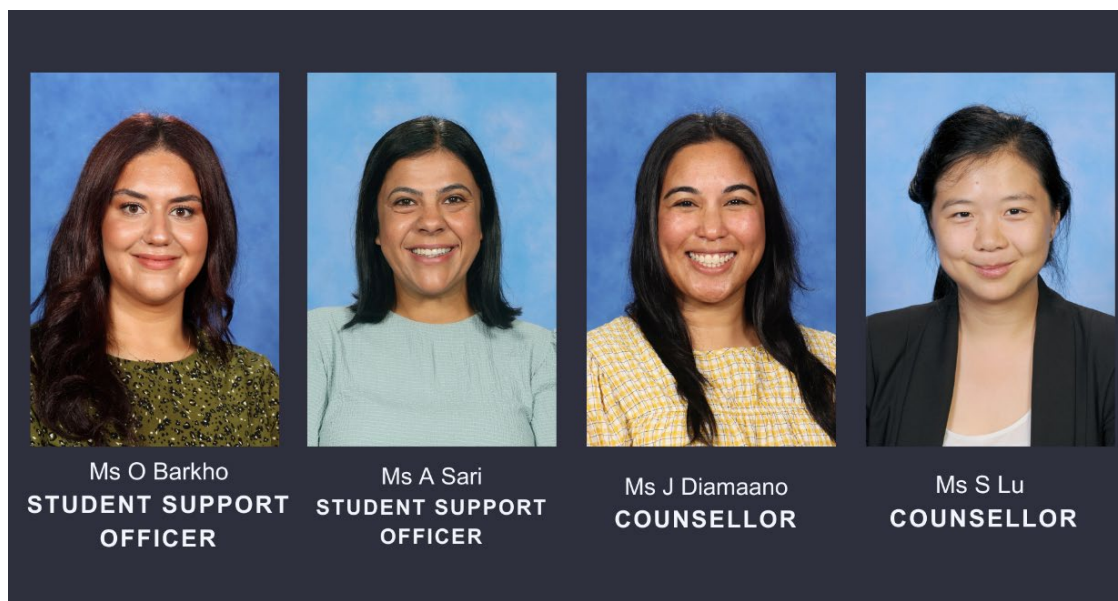

Ms O Barkho  
**STUDENT SUPPORT  
OFFICER**



Ms A Sari  
**STUDENT SUPPORT  
OFFICER**



Ms J Dimaano  
**COUNSELLOR**



Ms S Lu  
**COUNSELLOR**



FOCUSING on EXCELLENCE and SUCCESS



Education



# Your Mental Health Matters!

## Getting support at school

Sometimes life can be difficult. Stress, anxiety and feeling down can affect anyone, and quite often, it happens to a lot of us at some point in our lives. We all have good and bad days. However, if you're feeling sad, down or anxious and these feelings have started to affect what you would normally enjoy or do, then it's important to find out what's going on and what you can do about it.

## Who can you talk to?

You can speak with one of the school counsellors at our school. At Bossley Park High School, we have two counsellors, Julianne Dimaano (Tuesday & Thursday) and Shirley Lu (Monday, Wednesday & Friday). School Counsellors can help anyone who is experiencing difficulty with:

- Anxiety
- Anger
- Body image
- Self-esteem
- Bullying
- Family
- Grief and Loss
- Identity and Gender
- Stress

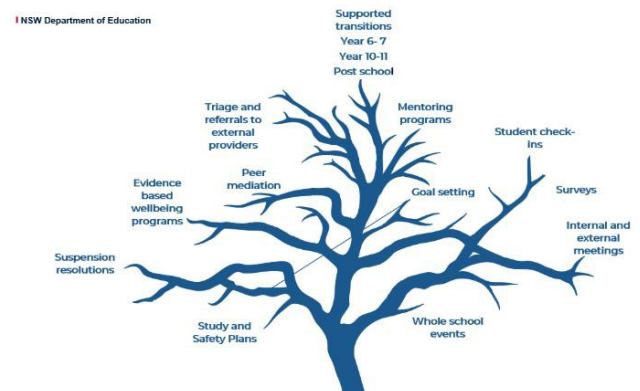

## How can you access the School Counsellors?

You can either self-refer or speak to one of your Year Advisers and they can refer on your behalf. We have self-referral slips which are located on Mr Zantiras' Wellbeing office door. You just simply fill out the form and place it under the door. Mr Zantiras will do the rest.

You can also speak to a trusted staff member such as your Year Adviser or request to see one of the Student Support Officers, Orhai or Angie via the Head Teacher Wellbeing, Mr Zantiras.

## How can you get support after hours?

**What is Mental Health?**

Mental health is how you **think, feel, and act** in everyday life.

Your **mental health is just as important as your physical health.**

Your mental health influences **how you handle stress, make decisions and relate to people.**

**No one in the world is free from problems.**

YAM



**Self-help Advice**

**What can make me feel better?**

- Try to have fun and laugh.
- Don't drink alcohol or use drugs to try to forget about your problems.
- Eat healthy, exercise and get enough sleep.
- Spend time with people that you like.
- Make sure you find time to do things you love doing every day. For example, listen to music, read a book, play a video game, watch a movie, write down your thoughts or simply relax.
- Look at your problems for what they are and try to think about how to solve them.

Some things are out of your control and you can't count on life to always treat you right. But you can make it a habit to treat yourself right.

**Be kind to yourself**

- Think about the decisions you make in everyday life and how they affect you and others around you.
- Telling others how you feel usually makes problems seem smaller and easier to solve. **Speaking to someone else can actually help you feel better.**
- You can't solve all your problems by yourself. By getting to know yourself better you will learn when you need help from others and to ask the right people for help.

YAM



# School Support Teams

**Learning Support** - The Learning Support faculty consists of specialist teachers whose main function is to assist students with their individual learning needs. In any one school there will be students who experience difficulties with learning. This could be because of the way they learn, the rates at which they learn or having second language learning barriers. These difficulties can also vary in cause, nature, intensity and/or duration.

Within the faculty, there are Learning and Support teachers, English as an Additional Language/Dialect (EAL/D) teachers and School Learning Support Officers. Each staff member brings with them a wealth of knowledge and experience that benefits the wellbeing and learning of students in their care. We assist in the transition of students with additional needs including primary to high school transition, cross-school transition and school to work transition. In addition to this, faculty staff members work with teachers from across the school and with a wide range of external agencies and specialists, in order to best support the learning needs of the students at Bossley Park High School.

**International Students** – Bossley Park High School offers a range of academic, welfare and engagement programs for international students. Working closely with the international student coordinator, international students' academic and welfare needs are monitored and catered for, as well as ensuring that they are abiding by the conditions of their visa. Along with developing their English language and literacy knowledge and skills, students are encouraged to take part in the social and wellbeing activities at the school, in extra-curricular activities and be active contributors to the school community.

**Refugee Students** – Bossley Park High School has a dedicated program of support for students who are identified as being refugee or have refugee-like experiences. Ranging from ensuring that new students settle in school and learning, additional language and literacy support, welfare and wellbeing monitoring and dedicated classes taught by specialist teachers; students with a refugee background are supported to ensure academic and wellbeing success. Working with Western Sydney University, the school runs the Refugee Action Support (RAS) Program whereby student teachers work closely with small groups of targeted refugee students to further develop their English language and literacy skills through KLA subjects.

**Aboriginal & Torres Strait Islander Students** – Bossley Park High School is committed to closing the achievement gap for Aboriginal & Torres Strait Islander students. We know that we need to learn about, nurture and value the cultural identity of our Aboriginal & Torres Strait Islander students in order to assist them to be successful learners. We welcome Aboriginal and Torres Strait Islander family members, parents and community members to our school so that we can get to know each other, learn about the local Aboriginal and Torres Strait Islander community and develop shared goals and plans for Aboriginal and Torres Strait Islander students.

A key component of Aboriginal & Torres Strait Islander Education at Bossley Park High School is to ensure that our teachers and students have a thorough understanding of Indigenous issues and that Aboriginal & Torres Strait Islander students are working at levels comparable to - or better than - their school and state cohort. The Bossley Park High School First Nations Committee work in partnership with the Fairfield AECG and meet regularly to coordinate activities and support the learning and engagement of our Aboriginal & Torres Strait Islander students.





# Student Representative Council (SRC)

## The role of the SRC

The SRC represents the students at the school. The group is comprised of 6-10 students per year group (7-12) as well as the four School Captains. The SRC have fortnightly meetings where an agenda is discussed, such as fundraising, volunteering and other ideas to help benefit the students at Bossley Park High School. The school Captains are invited to a "Captains Lunch" with the Principal where matters are discussed to benefit all involved at Bossley Park High School. The Student Representative Council are encouraged to listen to their peers and voice any suggestions or issues within the school at the appropriate meetings to be discussed.

## *SRC Coordinators*



Ms Grujovski  
English



Ms Volpe  
Mathematics

## School Captains 2025



From left to right - Riley Whicker, Hala Abed, Carisa Herrera, Addison Brgudac

The position of School Captain is a respected role that involves considerable responsibility and initiative. Captains are the leaders of the student body, and as such are role models for the students of Bossley Park High School. Exemplary conduct, presentation and fulfilment of duties are required at all times. School Captains and Vice Captains will:

- Complete leadership training
- Officiate at functions
- Speak confidently and expressively at assemblies and other school events such as hosting Performance Evening
- Represent the interests of the Bossley Park High School student body
- Demonstrate leadership and be a role model for junior members of the SRC
- Attend and lead regular SRC meetings and take an active role in student representation of the school and in the community
- Demonstrate initiative and creativity in leading SRC priorities within the school
- Liaise with teachers, Deputies and the Principal on matters of importance to the students
- Organise and attend regular meetings with the Principal and CSG



FOCUSING on EXCELLENCE and SUCCESS



Education



# House System

Students will be allocated a House for vertical roles and the promotion of house spirit.

EDINA	GANDANGARA	SARTOR	TARBURTON
-------	------------	--------	-----------

## The role of the House Captains and House Vice Captains

The position of House Captains and Vice House Captains is a respected role that involves **considerable responsibility** and **initiative**. House captains are the house and sport leaders of the student body, and as such are **role models** for the students at Bossley Park High School.

### House Captains and Vice-Captains will:

- Attend regular House Captain meetings
- Join the school's Interact Club, to develop and work on projects to help the school and the wider community
- Act as role models and leaders from their houses in all school activities
- Be active participants in the full range of House activities
- Organise and lead student teams at school swimming, cross country and athletics carnivals
- Motivate and encourage students within their houses to participate in school swimming, cross country and athletics carnivals
- Participate in Year 7 orientation days and activities
- Always demonstrate exemplary presentation and conduct to provide strong leadership and guidance for the members in their House.



*Jersey Day*



# Interact Club

*Interact Club  
Coordinator*

Bossley Park High School's Interact Club has been giving students the opportunity to make a real difference in the school and wider community. Our Interact Club meets once a fortnight during the lunch break to discuss ways in which students can assist the school and the wider community. As part of the Interact Club, students are given the opportunity to:

- Connect with community leaders
- Develop leadership skills
- Encourage the school and community to make a difference
- Raising awareness within the school community on a range of social, mental and physical issues.



**Ms S Soth  
English**

In previous years, the Interact Club has contributed over \$3000 in funds to various causes. Some of the causes that the Interact Club have been involved in include Beanies for Brain Cancer, Relay for Life, BCNA's Pink Nun Day, Jeans for Genes Day, Harmony Day, Carols at Horsley Park and many more.

Interact Club members also attend numerous Leadership and Team-building Conferences that gives them the opportunity to network with other Interact Clubs in the district, explore ways of more effectively campaigning to support worthy causes, develop their confidence to lead and manage and fundraise more effectively in the school and in the community. The Interact Club is a great place to meet students from different schools and develop the essential communication, teamwork and leadership skills needed to succeed in the 21st Century.



Interact Club Members are students in Years 10, 11 and 12 who are interested in social issues, special causes, and being involved in local community activities. Students meet numerous times during each term to discuss and plan activities they're interested in, and ways that can make a difference in the lives of others, developing volunteering and team working skills, and learning about empathy along the way.

In 2025, Interact Club students will be participating in a number of events, such as Pink Buns for Breast Cancer, Mission Australia Sleep Out, Biggest Morning Tea, Bake Sales, Relay for Life and Beanies for Brain Cancer. Last year we held a Jersey Day, where students wore a Jersey with a gold coin donation, which helped raise around \$800 towards our total donations for at Relay for Life. At Relay for Life, we participated in a number of activities, such as human wheelbarrow race, box rally race and dancing, raising a total of \$5089 in our school's team, which is a huge group achievement in making a difference by funding support for cancer patients and research for cures.



# Staff List 2025

<b>Senior Executive Team</b>  <b>Principal</b> Mr C Hollis  <b>Deputy Principals</b> Mrs J Villanueva (Yr 7 & 10) Ms K Curic (Yr 8 & 11) (Rel) Mr T Panagiotakis (Yr 9 & 12)	<b>Learning Support</b> Ms L Roby (HT) Ms L Armstrong (Yr 8 Adviser) Mr J Bian (Yr 12 Adviser) Ms C Lam Ms K Rorimpandey Mr D Lazoroski	<b>Science</b> Ms S Pham (HT) Ms E Dagher Ms S Kaur Mr J Nekić Mr M Newton Ms D Nguyen Ms N Rahman	<b>Careers</b> Ms A Chehade Ms K Breski (Transition Adviser)
<b>English</b> Ms A Pabiona (Rel. HT) Ms N Faul (HT) Ms L Grujovski (SRC Coordinator) Ms L Hodge Ms A Baker Mr C Maia (Yr 11 Adviser) Mr D Nguyen Ms S Soth Ms L Tran (Yr 10 Adviser) Ms J Zeaiter (Yr 9 Adviser)	<b>School Learning Support Officers</b> Ms S Alasfar Mr Z Fares Ms R Martino Ms T Riddle Ms J Vogiatzis	<b>Lab Assistants</b> Ms M Luker Ms K Nieuwenhuizen Ms A Nissan  <b>Social Science</b> Mr J Frech (HT) Mrs V Kokokios Mr A Gosai Mr A Moser Ms R Sharma Ms J Calfodoro Mr L Vacarro (HT T&L)	<b>Library</b> Ms F Weir (Yr 12 Adviser)  <b>Library Assistant</b> Ms K Ferrington Ms P Wilson  <b>Canteen</b> Ms A Hzaife
<b>History/LOTE</b> Mr B Clark (Rel. HT) Ms K Curic (Rel. DP) Mr O Cavagnola Ms J Dundovic (Rel. HT Admin) Ms T Vulic Ms A Matic (Rel. HT T&L) Ms P Zallo	<b>Mathematics</b> Ms S Sampol (HT) Ms E Charbine Mr P Ferraccioli Mr D Huynh Ms G Lee (Yr 8 Adviser) Ms B Luong Ms J Jomaa Ms S Luong Mr M Nikolich Ms M Pacialeo Mr E Suhartono Ms L Todic Ms S Trikili (Robotics) Ms S Volpe (SRC Coordinator)	<b>Disability Support Unit</b> Mr S Viravong (HT) Mr K Hosni Ms P Jas Mr J Nicomedes Mr Z Akdeniz  <b>School Learning Support Officers</b> Ms D Calarco Ms M Calarco Ms E Ford Ms M Mediat Ms N Van Rosmalen Ms S Lentini Ms J Zaccaria	<b>Administration</b> Ms C Colosi Ms R Sylvester Ms R Thompson Ms C Marfia Ms M Philipp Ms M Demasi Ms P Wilson Ms M Breski Ms S Lentini Ms C Jones Ms R Safadi
<b>Home Economics</b> Ms M Lopez (HT) Ms S Moiler Ms G Singh Ms S Trigg (Rel. Year 7 Adviser)  <b>Home Economics Assistant</b> Ms E Foti	<b>PDHPE</b> Mr D Gaziler (HT) Mr N Zantiras (HT Wellbeing) Mr A Banks Ms T Bevilacqua Ms T Breski Mr J Haywood (TFP Coach) Mr J Lepore (Yr 9 Adviser) Mr B Leslie Ms A Lynch Mr J Misic Mr G Stanmore Ms A Yousef Ms I Poll	<b>Visual Arts</b> Ms Z Iaali (Rel. HT) Ms S Tarar (Yr 10 Adviser) Mr T Tan Ms P Whittaker Ms K LoBasso (PBL)  <b>Teaching and Learning</b> Mr L Vacarro (HT) Ms K Simic (HT) Ms L Jane (Rel. HT) M A Matic (Rel. HT)	<b>Business Manager</b> Ms A Ligori  <b>School Administrative Manager</b> Ms L Zappia  <b>IT Coordinator</b> Mr W Bennett  <b>Technical Support Officer</b> Mr R Melisi
<b>Industrial Arts</b> Mr G Agostino (HT) Mr V Maharaj Mr M Medcalf (Yr 7 Adviser) Mr S Scott (Robotics) Mr C Solis Mr G Warren	<b>Performing Arts</b> Ms M Lopez (HT) Ms S Wais (Rel. HT) Mr P Riddle (HT Admin) Ms E Ulbrand (Yr 11 Adviser) Ms A Maytom	<b>Counsellor</b> Ms J Dimaano Ms S Lu  <b>Student Support Officer</b> Ms O Barkho Ms A Sari-Daher	<b>Maintenance/Ground</b> Mr M Ligori Mr M Tui Mr N O'Neill (Farm) Mr A Gasperov (Farm)





# Important Uniform Requirements

## School Uniform Code and Procedures

A uniform dress code reinforces students' pride in their own appearance, instils recognition of themselves as an integral part of the school community, and assists in developing pride in representing their school.

Issues of equality, expense, and health and safety are also factors that contribute to the establishment of the Uniform Policy.

**The school has health and safety regulations which are in accordance with the Department of Education (DoE). These MUST be followed by all students at all times.**

### Footwear

- **Fully enclosed all black firm and sturdy leather lace-up shoes must be worn.**  
Not accepted: buckle-up shoes, ballet-style slip on shoes, suede or soft canvas style sport shoes, no coloured trim or coloured brand logo ankle high basketball-style boots, shoes with a heel greater than 3cms or platforms and boots of the Doc Martens or military style.

### Jewellery

- Unacceptable items of jewellery will be confiscated and sent to the Deputy Principal.

See below for uniform requirements for junior and senior students.

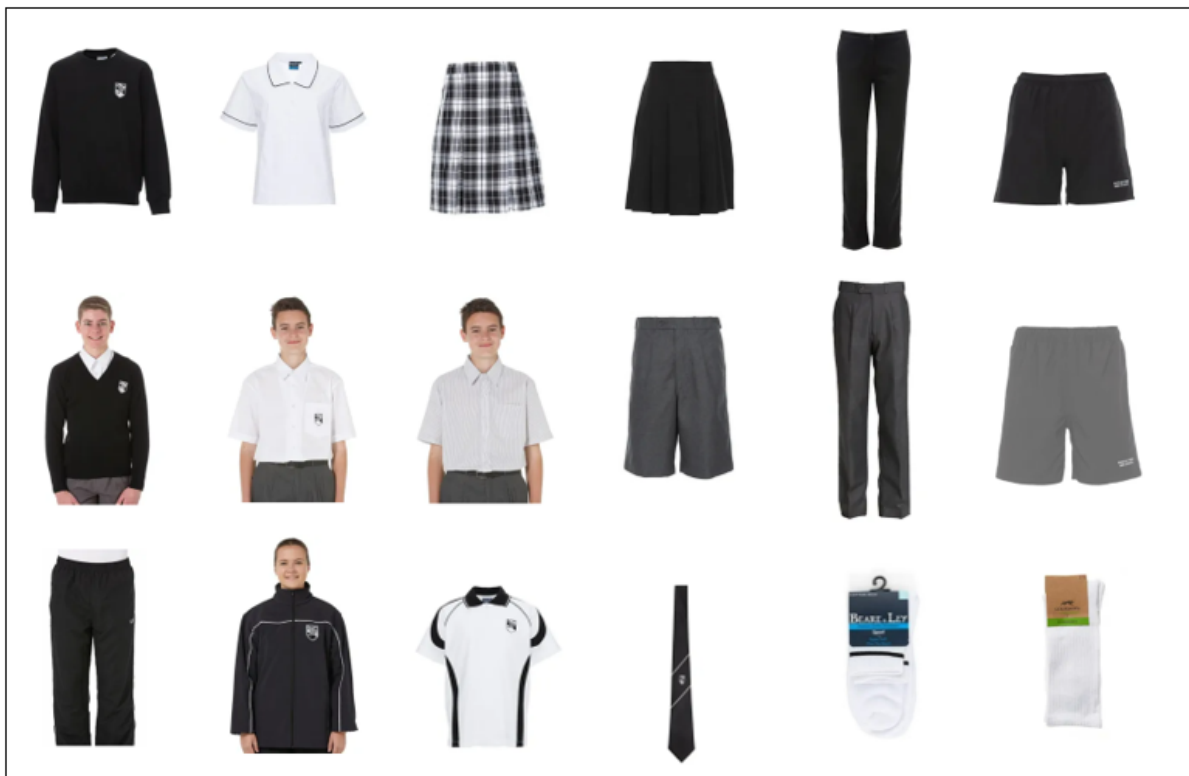





# Junior Uniform



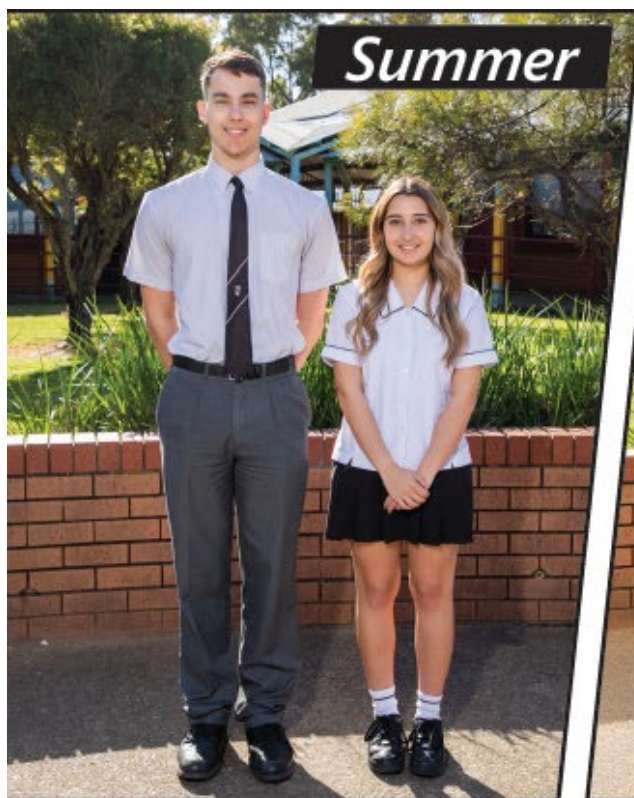

*Summer*



*Winter*



## *Senior Uniform*



# Attendance

## **Bossley Park High School's Individual Attendance Target is 95%**

Education for your child is vital. Regular attendance at school is essential for your child to achieve their educational best and increase their career and life options. NSW public schools work in partnership with parents to encourage and support regular attendance of children and young people. When your child attends school everyday, learning becomes easier and your child will build and maintain friendships with other children through social learning.

Research highlights a clear correlation between student attendance and the achievement of quality academic, socio-economic and health outcomes. This research tells us that students with an attendance rate below 90% are educationally at risk. **Above 95% is our expected student attendance.**

### **What is the school's expectation/standard for attendance?**

Students should have less than five days' absence, per year, in order to maximise progress, success and to maintain a connection with school life.

*When your child misses just one day per fortnight during their high school education, they will miss over 4 weeks of school per year and miss over one year over their school life.*

### **What are my legal responsibilities?**

Education in New South Wales is compulsory for all children between the ages of six years and below the minimum school leaving age. The *Education Act 1990* requires that parents ensure their children of compulsory school age are enrolled at, and regularly attend school, or, are registered with the Board of Studies, Teaching and Educational Standards for homeschooling.

### **The Importance of Arriving on Time**

Arriving at school and class on time:

- Ensures students do not miss out on important learning activities in the day
- Helps students learn the importance of punctuality and routine
- Gives students time to greet their friends and socialise before class begins
- Reduces classroom disruptions

## **LATENESS IS RECORDED AS A PARTIAL ABSENCE AND MUST BE EXPLAINED BY PARENTS**

### **What if my child has to be away from school?**

On occasion, your child may need to be absent from school. Justified reasons for student absences may include:

- Being sick, or having an infectious disease
- Having an unavoidable medical appointment
- Being required to attend a recognised religious holiday
- Exceptional or urgent family circumstance (e.g. attending a funeral)

Following an absence from school, you will be contacted to explain this absence. You must ensure that within seven days you provide the school with a verbal or written explanation for the absence. This can be done by phone, SMS, letter or email. For absences longer than a two-day duration, the school requires a medical certificate to explain the absence.





Principals may decline to accept an explanation that you have provided if they do not believe the absence is in the best interest of your child.

In these circumstances, your child's absence will be recorded as unjustified. When this happens, the principal will discuss their decisions with you and the reasons why.

Principals may request medical certificates or other documentation when frequent or long-term absences are explained as being due to illness. Principals may also seek parental permission to speak with medical specialists to obtain information to collaboratively develop a health care plan to support your child. If the request is denied, the principal can record the absences as unjustified.

## **Travel**

Families are encouraged to travel during school holidays. If travel during the school term is necessary, you must discuss this with the school principal. An *Application for Extended Leave – travel* may need to be completed. Absences relating to travel will be marked as leave on the roll and therefore contribute to your child's total absences for the year.

## **My child won't go to school, what should I do?**

You should contact the principal and school as soon as possible to discuss the issue and ask for help. Strategies to help improve attendance may include a referral to the school's learning and support team or linking your child with appropriate support networks. The principal may seek further support from the Home School Liaison Program to develop an Attendance Improvement Plan.

## **Working in Partnership**

The Department of Education recognises that working collaboratively with students and their families is the best way to support the regular attendance of students in school.

We look forward to working in partnership with you to support your child to fulfil their life opportunities.





# High Potential and Gifted Education

Bossley Park High School prides itself on enriching the learning of all students, not only those who have been identified as being high potential and gifted learners. We cater for the diverse learning needs and styles of each student and offer an enrichment program for our gifted and talented classes for Years 7 – 10.

The **High Potential and Gifted Education Policy** applies to all NSW public schools, teachers and students. It describes a framework to develop the talent of high potential and gifted students. The policy provides advice to implement effective learning and teaching practices.

The policy promotes engagement and challenge for every student in every school across intellectual, creative, social-emotional and physical domains of potential, while explicitly identifying and addressing the learning needs of high potential and gifted students.

Fundamental to the policy are issues of equity and excellence. High potential and gifted students have advanced learning capacity compared to same-age students and, as a result, require talent development opportunities and differentiated teaching and learning practices to ensure their specific learning needs are met.

High potential students are found among students of all backgrounds. Gaps in achievement, known as excellence gaps, may exist between different groups of high potential and gifted students unless specific support is provided. Such gaps further entrench inequality and disadvantage.

At Bossley Park High School, we are dedicated to meeting the needs of ALL students to ensure they meet their educational potential.

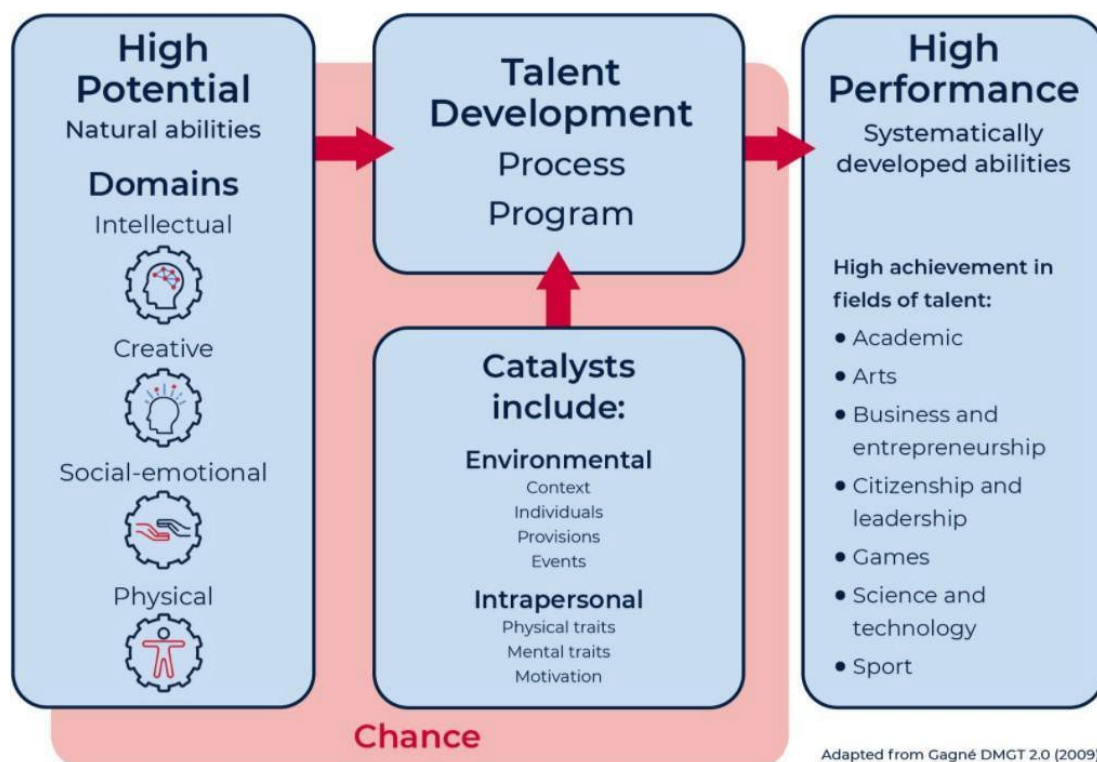



# High Potential and Gifted Education

## Intellectual

At Bossley Park High School we have two high performance classes in both Years 7 and 8. Students are selected to be in these classes through a combination of results from school and NAPLAN results. Students remain in this class for all core subjects including English, Mathematics, Science, Geography and History. Students that show potential in the intellectual domain may demonstrate the following learning characteristics:

- capacity for greater analytical depth
- fewer repetitions needed for mastery
- greater capability in abstract reasoning
- relative ease in making connections between disciplines
- advanced reading ability and comprehension
- knowledgeable in areas of passion
- processes information in complex ways
- enjoys hypothesising
- thrives on complexity and can see many points of view
- thinks in analogies

We offer a variety of opportunities for students to develop their potential in the intellectual domain. Some of the opportunities on offer include:

- Accelerated Mathematics
- Robotics Club
- Ethics Olympiad
- Inquisitive Minds Tournament
- Debating and Public Speaking opportunities

## Physical

Students that show potential in the physical domain may demonstrate the following learning characteristics:

- subtlety in movement and control of body
- coordinated, balanced and confident in physical activities
- high energy levels
- superior understanding of spatial relationships
- endurance, stamina and persistence in physical activities
- suitability of body build for area of physical high potential
- demonstrates prowess in physical activities common amongst age peers
- competitive
- 'hands on' learning preference

At Bossley Park High School, we offer a variety of opportunities for students to develop their potential in the physical domain. Some of the opportunities on offer include:

- Talented Football Program (TFP)
- Talented Netball Program
- Dance Ensemble
- Industry Professional Workshops
- State Representation opportunities





# High Potential and Gifted Education

## Creative

Students that show potential in the creative domain may demonstrate the following learning characteristics:

- educational risk-taking
- tolerance for ambiguity
- makes unusual associations between different ideas
- demonstrates creative thinking across domain areas and in the different disciplines
- demonstrates novel thinking in written and oral expression
- flexibility and divergence in thinking
- unusual ability for expressing self through art, dance, drama, music
- creates several solutions to a given problem
- synthesises a variety of ideas in original ways

At Bossley Park High School, we offer a variety of opportunities for students to develop their potential in the creative domain. Some of the opportunities on offer include:

- Game Changers Challenge
- Visual Arts -Art Hub, Visiting Artists and skill development workshops
- Extracurricular Workshops for Creative and Performing Arts
- Project Based Learning (PBL) Teaching and Learning Programs
- Write a Book in a Day Workshop



## Social-emotional

This program is designed to offer opportunities to students with a talent in Visual Arts. These opportunities include: students participating in extra-curricular workshops to extend and challenge their abilities, working with visiting artists to learn new skills and techniques and attend excursions and art galleries where students can appreciate art in different contexts.

Students that show potential in the social-emotional domain may demonstrate the following learning characteristics:

- advanced organisational and management skills
- advanced social and communication skills
- emotional stability
- empathy
- demonstrated leadership and decision-making skills
- resilient and self-aware
- foresees consequences and implications of decisions
- respected by peers
- self-confident
- task analysis and backwards mapping abilities
- social justice advocacy

At Bossley Park High School, we offer a variety of opportunities for students to develop their potential in the social-emotional domain. Some of the opportunities on offer include:

- Student Representative Council (SRC)
- Interact Club
- Entrepreneur Program
- Refugee Leaders Program
- Positive Behaviours for Learning (PBL) Committee





# Talented Football Program

The [Talented Football Program \(TFP\)](#) is the longest standing gifted and talented program at Bossley Park High School beginning in the early 1990's. The program has changed over the years, to the point where football is offered as a subject during sport and PDHPE elective classes with students learning in a practical and theory setting. The program provides a holistic approach to education for student athletes and is designed to provide additional training opportunities to support young players motivated to reach their potential, while at the same time pursuing a first-class education. The program aims to help provide more opportunities to players, develop additional player pathways, and support the long-term development of young players.

The Talented Football Program (TFP) is dedicated to providing a learning environment to maximise the football education of junior and youth players in order to assist them in attaining their goals of reaching an elite level within a variety of football career paths. The course is designed to educate and challenge student athletes in all aspects involved within the world of football. A specific focus is on the technical and tactical components of the game with sessions designed to create a competitive, as opposed to competition environment. Other areas covered include refereeing, coaching, media, sports, science and event management. Bossley Park High School has employed an international football coach to support the TFP.

TFP at Bossley Park High School has a rich and proud tradition of developing players that have represented their country and have gained professional playing contracts in Australia and abroad. The talented football staff work tirelessly to develop our current and future students, in achieving their dreams of playing professional football. Any enquiries can be directed to the school office or emailing [bossleypk-h.school@det.nsw.edu.au](mailto:bossleypk-h.school@det.nsw.edu.au) Your enquiry will then be passed onto the relevant person.

## The program includes:

- Boys and girls program, inclusive in each year group
- Weekly practical training sessions embedded into the timetable and curriculum
- Injury prevention program
- Referee accreditation
- Coaching accreditation
- Performance analysis
- Event Management training



## TFP program expectation:

Year 7 TFP is run in the allocated Sport period on the student's timetable. Identified students will take part in the Football competitions organised. Students may be expected to train before or after school as decided throughout the year.

Year 8–10 Students are encouraged to study the PASS elective that is designed for the TFP student.

Year 11 and 12 Students have the opportunity to elect the senior course Sport, Lifestyle and Recreation (SLR) to continue their studies in TFP. Please note: Students may be expected to train before or after school as decided throughout the year.

## TFP Staff

Devrim Gaziler- Head Teacher PDHPE & TFP

Julian Lepore – Sports Coordinator

Joe Haywood - Head Coach

Geoff Stanmore - Coach

Elvis DeMarchi - Goalkeeper Coach

Roberto Speranza - Physio

Alex Pucciarelli - Physio

Angel Lynch – Female Coach



FOCUSING on EXCELLENCE and SUCCESS



Education



# Robotics Club

The Bossley Park High School Robotics club has coined the phrase “Learning through Opportunity & Opportunity through Learning”. The clubs’ activities, ethos and ecosystem allow students to engage professionally, graciously and respectfully with peers, mentors, business, industry, universities, community, building skills of the future through robotics, technology, electronics, and programming. The students are empowered and given opportunities to engage in outreach programs to assist their local community, their school, local schools, and even internationally, spreading their love of Robotics and Science, Technology, Engineering and Mathematics (STEM).



Ms S Trikilis  
**Mathematics**



Ms S Scott  
**Industrial Arts**

Each year our students engage in multiple National and International tournaments and events, giving our diverse students the opportunity to compete graciously and professionally.

Most of the tournaments engage students to meet challenges well beyond their capabilities, testing their STEM technical skills and knowledge, problems solving, creativity, team skills, communication and personal value systems. Students are taken out of their comfort zone and are given the opportunity to learn to engage with other students and mentors from other schools around Australia and Internationally.

The club has fostered many opportunities for graduating year 12 students, to showcase their passion and skills and have been granted pre-HSC University entry and scholarship programs in tertiary education at Macquarie University and UNSW because of their consistent engagement with the program. Students from the club have also developed entrepreneurial skills and student led businesses are beginning to grow, providing services and goods to communities and industry.

Much of the work developed within the Robotics Club has found its way into our curriculum through the Technology mandatory course in Stage 4, iSTEM (integrated STEM), IST and Industrial Technology Engineering course in Stage 5, Software Design and Development and Engineering Studies in Stage 6. The efforts of the club have found their way to our local newspapers and to the Department of Education conferences on STEM education and future learning. We can’t help but acknowledge and show our appreciation to Bossley Park High School, FIRST Australia, Google, Ford, Lego Education, AARNET, Sydney University, and many more that have helped and supported the work.

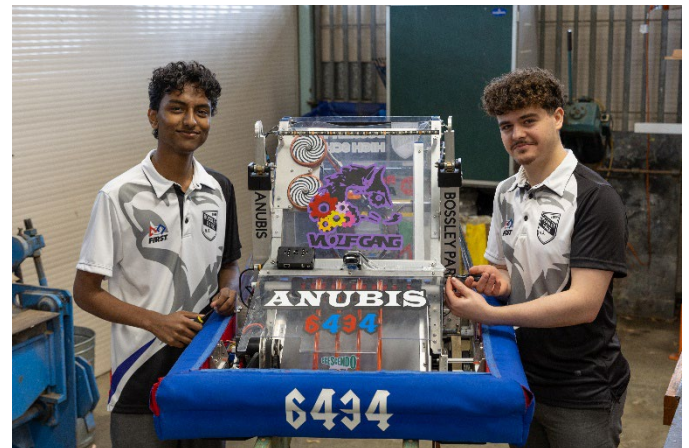

FOCUSING on EXCELLENCE and SUCCESS



Education



# Bring Your Own Device (Senior's)

## Why BYOD?

BYOD (Bring Your Own Device) refers to students being allowed to bring a personally owned device to school to complement their learning in the classroom. In this digital age students need to be highly skilled and productive users of technology to prepare them for a rapidly changing workforce. Students will learn to solve problems collaboratively and creatively and learn to use technology safely and ethically. Senior students will certainly benefit from having their own device at school

## Which device?

Senior students may bring a laptop or notebook computer to school. The device should meet the specifications recommended by the school below. The device can be purchased from any computer retailer, Harvey Norman, JBHIFI, Bing Lee etc.

## Device specifications:

- **Wireless connectivity**  
Devices must support the **802.11n 5GHz** wireless dual band wireless standard. Devices that do not meet this standard will not be able to connect to our network.
- **Operating system**  
Devices should have the current or a recent version of the relevant operating system installed, such as Windows 11 or MacOS 16.0.
- **Battery life**  
Devices must have at least 7 hours of battery life without charging. Devices must be fully charged before school each day. Students are not permitted to charge devices at school. It is the student's responsibility to ensure their device is fully charged each day.
- **Hardware, storage and RAM**  
Devices should have a screen size of 13 inches, an appropriate keyboard, USB connectivity and inbuilt webcam and microphone. They should have 256GB storage and 8GB RAM.
- **Software and apps:**  
Devices should have a web browser installed. Students are offered free Microsoft 365 and Adobe Creative Cloud. If students require assistance in obtaining free software, please see the Technical Support Officer (TSO).
- **Getting involved:**  
To begin using your device at school, students and parents must sign the BYOD user charter and return it to the TSO's office. Students must always keep their devices safe and secure and ensure that use of devices is in accordance with Bossley Park High School and Department of Education policies.

The school IT Support Staff are available to assist you with connecting your device to the school's network. Mr W Bennett (IT Coordinator) is located in the Front Office and Mr R Melisi (TSO) is located in the Home Economics building opposite the Home Economics Staffroom.





# Core Rules

## Core Rules for students in NSW Government Schools

Students in NSW government schools are provided with a high-quality education so that they may learn to the best of their ability and become self-disciplined, tolerant, enterprising and contributing members of the school and community.

The Behaviour Code for students has been developed to establish consistent expectations in all government schools in support of these aims.

This code promotes learning, wellbeing and safety of all students in NSW Public schools which is a high priority for the Department of Education. We implement teaching and learning approaches to support the development of skills needed by students to meet our high standards for respectful, safe and engaged behaviour.

The critical role of parents and carers is recognised as the primary influences on each child's character and behaviour and as essential partners in supporting the core rules and the successful education of their children.

The Department is committed to supporting principals and school staff in the implementation of this code through statewide policies and programs, together with regional support staff, professional learning and alternative provisions, in order to promote the highest standards of behaviour and learning in our schools.

These rules are based on our core values of integrity, excellence, respect, responsibility, cooperation, participation, care, fairness and democracy.

The critical role of parents and carers is recognised as the primary influence on each child's character and behaviour and as essential partners in supporting the core rules and the successful education of their children.

The Department is committed to supporting principals and school staff in the implementation of these rules through statewide policies and programs, together with regional support staff, professional learning and alternative provisions, in order to promote the highest standards of behaviour and learning in our schools.

### The core rules

All students in NSW are expected to:

- Respect other students, their teachers and school staff and community members
- Follow school and class rules and follow the directions of their teachers
- Strive for the highest standards in learning
- Respect all members of the school community and show courtesy to all students, teachers and community members
- Resolve conflict respectfully, calmly and fairly
- Comply with the school's uniform policy or dress code
- Attend school every day (unless legally excused)
- Respect all property
- Not be violent or bring weapons, illegal drugs, alcohol, tobacco or vapes into our schools
- Not bully, harass, intimidate or discriminate against anyone in our schools.





# Core Values

The Government recognises the importance of the following core values to the community. These values represent the aspirations and beliefs of the Australian community as a whole, including its concern for equity, excellence and the promotion of a caring, civil and just society.

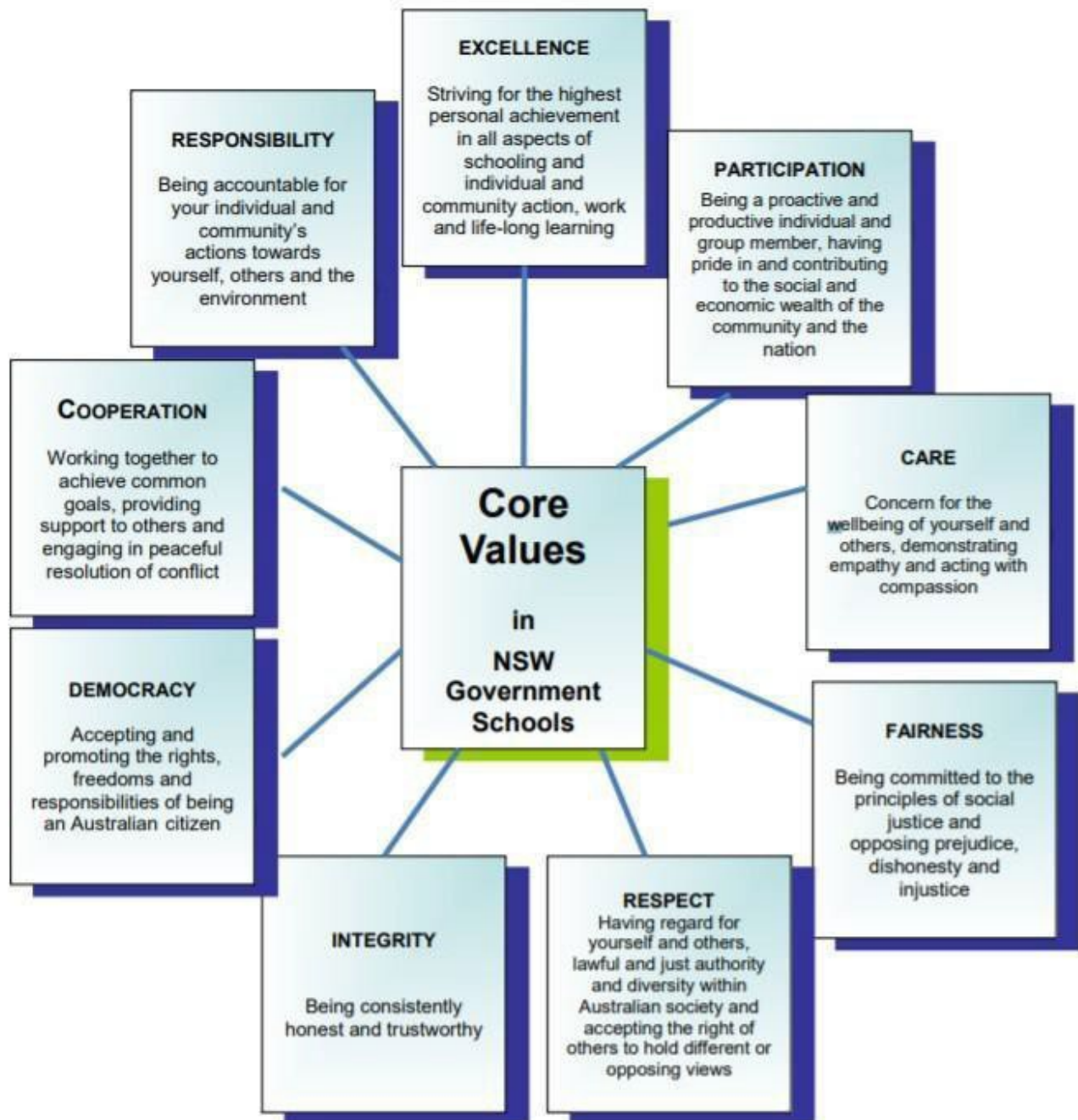

Core values in NSW Government Schools



# School Safety

Schools and their communities work together to provide quality learning environments which are:



All students and staff have the right to be treated fairly and with dignity in an environment free from disruption, intimidation, harassment, victimisation and discrimination. To achieve this, all schools are expected to maintain high standards of discipline. ***(Related policy – Suspension and Expulsion of School Students Procedures)***.

There will be cases of unacceptable behaviour where it will be in the best interests of the school community and/or student involved, for the student to be removed from the school for a period of time or completely. This may apply in the following circumstances:

- Causes **actual harm** to any person; or
- Poses an **unacceptable risk to health and safety, learning, and/or the wellbeing** of any person, including where such a risk is posed by:
  - bullying
  - cyber bullying
  - drugs in schools
  - weapons and knives in schools
  - assault
  - racism or discrimination, including that based on sex, race, religion, disability or sexual or gender orientation
  - mis use of technology



# Mobile Phone Policy

To ensure the safety of students is prioritised and that educational outcomes for students are maximized, through the appropriate use of technology, mobile phones are not permitted at school. This procedure has been developed by Bossley Park High School in consultation with the Community Support Group (CSG).

**Mobile phones and earphones/airpods must not be used on school premises for any purpose. (this includes the classroom and playground)**

Every student at BPHS will be assigned a personal Yondr Pouch. While the Yondr Pouch is considered school property, it is each student's responsibility to bring their Pouch with them to school every day and keep it in good working condition.

## DAILY PROCESS

As students **arrive to School**, they will:

1. Turn their phone off.
2. Place their phone inside their Pouch and secure it **before entering school grounds**.
3. Store their Pouch in their backpack for the day.

At the end of the day, students will open their Pouch using unlocking stations located near school exits, remove their phone, and put their Pouch in their backpack. Students must bring their Pouch to school with them each day.

\*Students arriving late or leaving early will pouch/unpouch their phones in the front office under the supervision of office staff.

## Pouch Damage / Lost Pouch / Using Phone During School

If a student damages their Pouch, they will be expected to pay a replacement fee of \$20 to replace the Pouch.

Examples of damage:

- Deep scratches on the globe and on the green ring around it
- Bent pins
- Pin and button not fully recessing, due to pin damage

## Forgotten Pouch

If a student forgets their Pouch, **their phone will be confiscated, and school staff will call home to remind the Parent of the policy**. The phone will be returned to the student at dismissal.

If parents need to make contact with their child during school time they can ring the school's front office 9823 1033. If students need to ring home they are to seek assistance by speaking with the senior executive or front office.

**This procedure applies to all students at BPHS.**

Mobile phone usage in classrooms generates substantial barriers to student engagement and student learning. Their use within the playground has also generated issues affecting the safety of students such as bullying and the distribution of inappropriate content, including video.

Students who fail to comply with the school's procedure within school grounds will be sent to the Deputy Principal to hand in their mobile phones or earphones/Airpods. The Deputy Principal will keep the phone in a secure location and record the student's name and the date. The mobile phone or earphones/AirPods will be returned to the student at the end of the school day. Persistent inappropriate use of mobile phones will be managed through the school's welfare and discipline policy.





# Merit Awards

## Positive Rewards to Recognise and Reinforce Student Behaviour

It is essential that students receive recognition for good behaviour, responsibility, effort and achievement. Teachers reinforce positive behaviour by utilising the school systems, in combination with their own or faculty recognition schemes. This aspect has been enhanced by the Positive Behaviours for Learning program (PBL) which shifts the focus from discouraging inappropriate behaviour to encouraging appropriate behaviour, so that students will become safe, respectful learners.

<b>High Achievement</b> <ul style="list-style-type: none"><li>• Improvement, consistency, excellence, sustained good effort, cooperation, participation, quiet achiever, etc.</li></ul>	<b>Outstanding Engagement</b> <ul style="list-style-type: none"><li>• Most improved, or personal growth in their learning</li></ul>	<b>Sport</b> <ul style="list-style-type: none"><li>• Improvement, consistency, excellence, sustained good effort, cooperation and participation, quiet achiever, good sportsmanship, etc.</li></ul>
<b>School Representation</b> <ul style="list-style-type: none"><li>• Sport, debating, public speaking, interschool competitions, forums, displays, etc.</li></ul>	<b>School and Community Service</b> <ul style="list-style-type: none"><li>• Returning valuable lost property, charity work, helping at school functions / volunteering for school programs, assembly participation, work experience, etc.</li></ul>	<b>Safe, Respectful, Learner</b> <ul style="list-style-type: none"><li>• I will complete all my work to the best of my ability.</li><li>• I will follow the teacher's instructions.</li><li>• I will bring correct equipment to every lesson.</li><li>• We will listen to each other.</li><li>• We will speak to each other in a positive manner.</li></ul>



### Junior students – Achieving Plus 2:

1. Collect 5 white merit awards from DIFFERENT SUBJECT AREAS for academic performance, attitude/effort, sport, service or school representation
2. Get a MAC card and fill it out with the details of your merit awards
3. Put your completed MAC card and merits in the box outside the Head Teacher Student Wellbeing's office
4. Receive your award at assembly and you are eligible for the Plus 2 excursion.

### Junior students – Achieving Plus 3:

1. Reach Plus 2 level
2. Collect another 10 white merit awards from ANY SUBJECT AREA and complete your MAC Card.
3. Put your completed MAC cards and merits in the box outside the Head Teacher Student Wellbeing's office
4. Receive your award at Presentation Evening and you are eligible for the "Student of the Year" Award.

### Senior students – Achieving Plus 2:

1. Collect 4 white merit awards from DIFFERENT SUBJECT AREAS for academic performance, attitude/effort, sport, service or school representation
2. Get a MAC card and fill it out with the details of your merit awards
3. Put your completed MAC card and merits in the box outside the Head Teacher Student Welfare's office
4. Receive your award at assembly and you are eligible for the Plus 2 excursion.

### Senior students – Achieving Plus 3:

1. Reach Plus 2 level
2. Collect another 8 white merit awards from ANY SUBJECT AREA and complete your MAC Card.
3. Put your completed MAC card and merits in the box outside the Head Teacher Student Welfare's office
4. Receive your award at Presentation Evening and you are eligible for the "Student of the Year" Award.

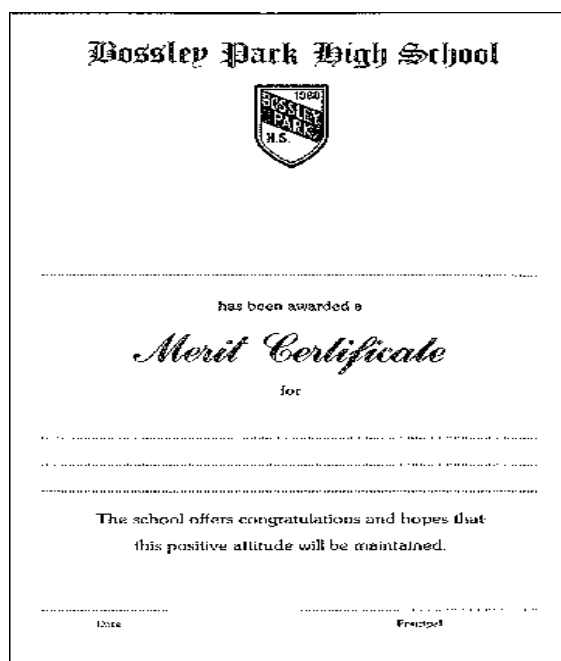



# PBL Reward System



**PROMOTING POSITIVE  
BEHAVIOURS IN LEARNING**

- 1. EARN POINTS FROM YOUR TEACHERS  
FOR BEING SAFE, RESPECTFUL  
LEARNERS.**
- 2. POINTS ARE ENTERED IN SENTRAL  
AND ARE TALLIED EVERY TERM.**
- 3. RECEIVE 20 POINTS IN A TERM TO  
EARN AN END OF TERM REWARD**





# School Library

The Bossley Park High School Library is a well-stocked and resourced facility that can be utilised in many ways.

**Head Teacher  
Librarian  
Ms F Weir**



## **Borrowing:**

The library has a generified Fiction Section and well-signed Non-Fiction Section. Students need to have a Library ID card to borrow books and equipment. They will be issued with one at the start of their schooling or can purchase a replacement card for \$6 at any time from the library staff.

## **Technology:**

The library has several computers and laptops for students to access. They can be used during class time or breaks; however, they cannot be taken outside of the library.

## **Printing:**

Students may make use of the library printer for a small fee. It prints in both black and white and colour in sizes A4 and A3. All students are provided with a one-off \$5 printing credit on enrolment. Students are encouraged not to leave printing of assessments to the last minute, as the library may need to be closed due to exams or special events on rare occasions.

## **Study Periods:**

Senior students who attend TAFE or other training courses may have study periods on their timetable. During these times they attend the library at the beginning of the period, have their name marked off and remain in the Senior Areas to be supervised. They will have access to the library's resources for their private study.





# Agriculture

Bossley Park High School has a farm, which is used by students studying Agriculture. Throughout the year, we keep a variety of animals at the farm including layer hens, meat chickens, ducks, goats, sheep, pigs, guinea pigs, bees, and dairy calves. We also grow many different crops including citrus fruit, vegetables, and herbs. Students who study Agriculture will take part in the raising of these crops and animals.

In Year 7, Agriculture is a component of the Technology (Mandatory) course. All students study Agriculture for 13 weeks. Agricultural Technology is an elective course that can be studied by students in Years 8, 9 and 10. Agriculture can also be studied in Years 11 and 12 for the HSC.

Students may choose to join our Agriculture Show Team and exhibit some of our animals at annual agriculture shows such as the Royal Easter Show and the Penrith Show. Students interested in joining the Agriculture Show Team can see Ms Dagher in Science.





# Disability Support Unit

## Faculty Vision

Our vision is to give students with disabilities the best educational opportunities, experiences, and skills to help them succeed in life.

## Our Aims

To create safe and supportive learning environments where students are encouraged to take risks in their learning, to explore, grow and develop in their journey towards greater independence and self-advocacy. To deliver innovative and meaningful learning experiences to establish a culture of inclusion and participation in the wider-school community including programs with their non-disabled peers. To develop and foster positive partnerships with parents and caregivers to ensure every student is known and valued as well as empowering students with disabilities to take control of their own lives.

## Accessibility

Accessibility features currently available for students with physical disabilities at Bossley Park High School include:

- A wheelchair accessible school bus for use on excursions and community access
- Accessible toilet and shower facilities including handrails, ceiling and portable hoists
- Wheelchair accessible classrooms with height adjustable tables
- DSU COLA (covered outdoor learning area)
- Stage lift for wheelchair access in school's multi-purpose centre
- Outdoor exercise
- Sensory Space

## Technology:

Adaptive technologies currently available for students with physical disabilities at Bossley Park High School include:

- Adaptive equipment such as pencil grips, slope boards, height adjustable desks, foot supports, book holders and cooking utensils
- A dedicated wheelchair-accessible computer laboratory with adapted access and hardware features
- Clevertouch Interactive Panels/Whiteboards
- Class set of Laptops
- Class set of iPads

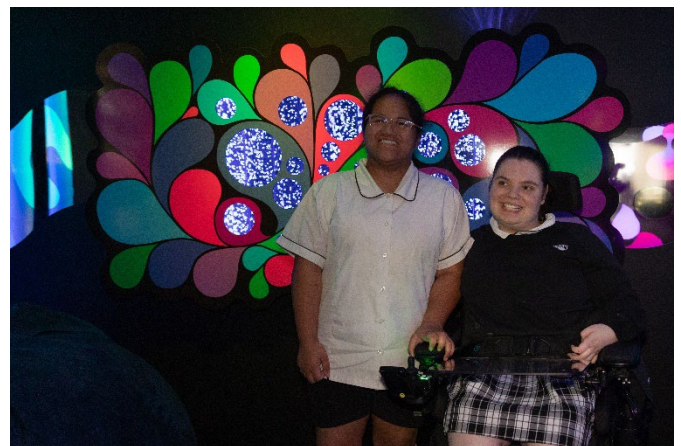



# Careers Department

## Careers Adviser

At Bossley Park High School, we are committed to working collaboratively with students, parents and caregivers to assist students to explore their interests by providing, opportunities and choice across post-school pathways including university, TAFE, training and vocational options, and access to optional work experience for students. We strive to ensure that every student will be well-equipped to transition from Bossley Park High School ready to succeed in their chosen pathway as informed and responsible citizens.

Bossley Park High School is a participating Educational Pathways Program (EPP) School. The Educational Pathways Program is designed to improve higher education and career outcomes for young people. The Educational Pathways Program is made up of 8 individual initiatives that all participating schools have access to including SBAT, Start Your Future, Job Readiness Workshops, VET Ambassadors, Apprenticeship and Traineeship head start, Back in the Game and TAFE NSW Early School Leavers. These initiatives are supported by the Head Teacher Careers and allow for Bossley Park High School to offer various post school pathways catering for a diverse student body.

### The Careers department can:

- Conduct personal interviews with students from years 10, 11 and 12
- Explore various career pathways and post school options.
- Offer programs of assistance that will benefit the student before they finish school, for example, work experience.
- Coordinate and work with students who identify an interest in Vocational pathways SBAT, TVET, EVET and support students with subject selection.
- Foster links with universities to allow student access to various programs including, UNSW Gateways Program, Western Sydney University- Fast Forward Program
- Deliver information sessions to explain UAC (University Admissions Centre), University processes including applications, early entry, SRS (Schools Recommendation Scheme)
- Organise information sessions to be delivered by university specialists and/or representatives.

Ms A Chehade



## Head Teacher Secondary Studies

The Head Teacher, Secondary Studies, oversees the Careers Faculty creating and strengthening new and existing partnerships between the school, industry, and outside agencies. The Head Teacher Secondary Studies promotes effective communication strategies between young people, the school, external agencies, and the Fairfield LGA by seeking local solutions. They utilise community support to develop and deliver programs for those students most likely to disengage from school early. They provide links with Local Community Partnerships, additional educational pathway providers, and other local community initiatives to seek additional opportunities for students.

To support the diverse requirements of post school pathways, the Head Teacher, Secondary Studies works with students to obtain credentials including delivery of white card, Start Your Future, Bossley Employability Skills Program (BESP), Careers NSW initiatives and support, individualised transition discussions, subject selection support and provides students with invaluable information regarding NESA RoSA requirements.





## Transition Adviser

The Transition adviser supports the school and students in ensuring that all students are known, valued and have the opportunity to engage in activities and programs to prepare them for successful transitions to further education, training or employment. Transition advisers acknowledge that all NSW public school students have a right to an inclusive learning environment and to feel happy and safe at school.

The transition advisers collaborate with local community, industry organisations and government agencies to deliver and support innovative and engaging programs that meet the needs and aspirations of the school's identified groups of students.

The Transition Adviser works closely with the Careers Adviser to ensure students are work ready, and know their post school pathway options, aiming to develop good connections with students through mentoring and advocacy, which will support young people in the various stages of transition. They work alongside the young person, and significant adults (teachers, parents/carers, employers, youth workers) to translate the young person's transition/retention plan into action. The transition adviser and career adviser roles are complementary.

Ms K Breski





# Curriculum

## Year 7

Subject	Periods each fortnight
English	4
Mathematics	4
Science	4
History	4
PD/H/PE	3
Technology	4
Music	4
Visual Arts	4
Languages (Spanish)	4
Sport	2
Literacy	2

## Year 8

Subject	Periods each fortnight
English	5
Mathematics	6
Science	6
Geography	4
PD/H/PE	4
Technology	4
Sport	2
Literacy	2
Electives x2	6

### Human Society and its Environment

- Commerce
- History

### Science

- Agriculture

### Languages other than English

- Spanish
- Italian

### Personal Development / Health / Physical Education

- Talented Football

### Technological and Applied Studies

- 3D Design
- Computer Aided Engineering
- Food Technology
- iSTEM (Robotics and Coding)
- Industrial Technology - Timber
- Information Software Technology

### Creative and Performing Arts

- Dance
- Drama
- Music

### Visual Arts

- Visual Arts
- Design





# Curriculum

## Year 9

Subject	Periods each fortnight
English	5
Mathematics	6
Science	5
Geography	4
History	4
PD/H/PE	4
Sport	2
Electives	8
Literacy	1

## Year 10

Subject	Periods each fortnight
English	6
Mathematics	6
Science	6
HSIE	4
PD/H/PE	4
Sport	2
Electives	10
Careers	1

<b>Mathematics</b> <ul style="list-style-type: none"> <li>Accelerated Mathematics (Invitation Only)</li> </ul>	<b>Technological and Applied Studies</b> <ul style="list-style-type: none"> <li>Food Technology</li> <li>Industrial Technology - Timber</li> <li>Industrial Technology - Engineering</li> <li>Industrial Technology - Graphics</li> <li>iSTEM</li> <li>Textiles Technology</li> </ul>
<b>Human Society and its Environment</b> <ul style="list-style-type: none"> <li>Commerce</li> <li>Philosophy</li> <li>History Elective</li> </ul>	<b>Creative and Performing Arts</b> <ul style="list-style-type: none"> <li>Dance</li> <li>Drama</li> <li>Music</li> </ul>
<b>Languages other than English</b> <ul style="list-style-type: none"> <li>Spanish</li> </ul>	<b>Visual Arts</b> <ul style="list-style-type: none"> <li>Visual Arts</li> <li>Visual Design</li> <li>Photography</li> </ul>
<b>PDHPE</b> <ul style="list-style-type: none"> <li>Physical Activity and Sports Studies</li> <li>Talented Football (Invitation Only)</li> </ul>	



# Charges & Administration Costs

## Year 7

Description	Charge
Administration Charge	\$50.00
CSG Levy	\$2.00
E-Learning	\$38.00
Year 7 Swim School 2025	\$60.00
Sport Charge	\$40.00
<b>MANDATORY TOTAL</b>	<b>\$190.00</b>
<b>Talented Football Program</b>	\$1,000.00

## Year 8

Description	Charge
Administration Charge	\$50.00
CSG Levy	\$2.00
E-Learning	\$38.00
Sport Charge	\$30.00
Elective Courses	\$30.00
<b>MANDATORY TOTAL</b>	<b>\$150.00</b>
<b>Talented Football Program</b>	\$1,100.00
TFP students will be required to pay for 1 elective course charge	\$15.00

## Year 9

Description	Charge
Administration Charge	\$50.00
CSG Levy	\$2.00
E-Learning	\$38.00
Sport Charge	\$20.00
Elective Courses	\$50.00
<b>MANDATORY TOTAL</b>	<b>\$160.00</b>
<b>Talented Football Program</b>	\$1,100.00
TFP students will be required to pay for 1 elective course charge	\$25.00

## Year 10

Description	Charge
Administration Charge	\$50.00
CSG Levy	\$2.00
E-Learning	\$38.00
Sport Charge	\$20.00
Elective Courses x2	\$50.00
<b>MANDATORY TOTAL</b>	<b>\$160.00</b>
<b>Talented Football Program</b>	\$1,100.00
TFP students will be required to pay for 1 elective course charge	\$25.00





# Charges & Administration Costs

## Year 11

Description	Charge
Administration Charge	\$50.00
CSG Levy	\$2.00
E-Learning	\$38.00
Senior Textbook Hire	\$50.00
Sport Charge	\$20.00
Courses	\$100.00
<b>MANDATORY TOTAL</b>	<b>\$260.00</b>
Additional Charges	Charges
Hospitality Cookery Uniform	\$92.50
Hospitality Food and Bev Uniform	\$70.00
<b>Talented Football Program</b>	<b>\$1,100.00</b>
TFP students will be required to pay for 4 elective course charge	\$80.00

## Year 12

Description	Charge
Administration Charge	\$50.00
CSG Levy	\$2.00
E-Learning	\$38.00
Sport Charge	\$20.00
Courses	\$100.00
<b>MANDATORY TOTAL</b>	<b>\$210.00</b>
Additional Charges	Charges
Senior Textbook Hire <i>(if commencing at BPHS in Yr12)</i>	\$50.00
<b>Talented Football Program</b>	<b>\$850.00</b>
TFP students will be required to pay for 4 elective course charge	\$80.00



*Deputy Premier & Minister for Education Visit May 2024*



# Canteen Menu

## BOSSLEY CANTEEN MENU

### DAILY SPECIALS - ON A ROTATING BASIS \$7

#### MONDAY

Bowl Day

#### TUESDAY

Wrap Day

#### WEDNESDAY

Burger Day

#### THURSDAY

Potato, Pasta, Pizza or Protein Day

#### FRIDAY

Butter Chicken OR Chicken, Cheese & Avo

Turkish Roll

### HOT FOOD

Pasta Nap	\$ 4.00
Falafel Wrap	\$ 7.00
Butter Chicken & Rice	\$ 7.00
Toasted Cheese Wrap	\$ 3.50
Toasted Cheese & Ham Wrap	\$ 4.50
Chicken Skewer	\$ 4.00
Meat Pie	\$ 5.50
Sausage Roll	\$ 5.00
Chicken Chippies (6)	\$ 4.00
Garlic Bread	\$ 1.00
Sweet Chilli Chicken Burger	\$ 7.00
Lasagna	\$ 7.00
Chicken Noodle Cup	\$ 4.00
Potato Jacket	\$ 7.00
Spinach & Fetta Roll	\$ 4.50
Potato Gems (10)	\$ 4.00
Devil Wings	\$ 6.00

### HOT BREAKFAST FOOD

Sausage & Egg Wrap	\$5.00
Pancakes	\$4.50
Toasted Cheese Wrap	\$3.50
Toasted Ham & Cheese Wrap	\$4.50
Fresh Banana Bread/Muffins	\$3.50

### FROZEN

Juicies	\$ 2.00
Zooper Dooper	\$ 1.00
Frozen Yoghurt	\$ 2.50
Chocolate Super Pop	\$ 2.50

### SANDWICHES - ROLLS EXTRA 50c

Hommus, Chicken, Lettuce,	
Cucumber	\$6.00
Ham Salad	\$7.00
Tuna Salad	\$7.00
Cheese & Tomato	\$4.50
Chicken, Cheese & Avo	\$5.50
Ham, Cheese & Tomato	\$5.50
Avocado, Cheese Salad	\$7.00
Egg, Lettuce & Mayo	\$5.50
Chicken, Lettuce & Mayo	\$5.50
Salad	\$7.00

### FRESH COLD FOOD OPTIONS

Chicken Cesar Salad	\$6.00
Chicken Garden Salad	\$7.00
Greek, Chicken Salad	\$7.00
Sushi	\$4.00

### SNACKS

Watermelon Cups	\$6.00
Mango Chia Cup	\$7.00
Low Fat Yoghurt & Museli Cups	\$7.00
Custard Cups	\$4.00
Popcorn	\$2.00
Cinnamon Crisps	\$2.00
Red Rock Deli Chips	\$2.00
Mango Chips	\$2.50
Cereal Cup \$2.00 With Milk \$2.50	

### DRINKS

Water	\$ 2.50
Sparkling Water	\$ 3.50
Nippy's Milk 250ml	\$ 2.99
100% Juice - Orange/Apple	\$ 3.50
Groove	
Up & Go - Choc/Vanilla/S-Berry	\$ 3.50
Waterfoods - Lemon/Lime	\$ 4.00
Aloe Lychee	\$ 4.00
Hot Chocolate	\$ 3.50







## Parent Portal: Make a payment

**The School Bytes parent portal enables you to view all your children in one portal and process payments for multiple siblings in one transaction.**

Once your portal is activated you can use it to give consent for events, process online payments and view the school calendar.

**Please note:** Transactions made through the online payment portal will appear on your bank statement as 0SCHOOLSONLINE 0000 PARRAMATTA AU.

### Detailed steps

#### 1. Log into the parent portal –

<https://portal.schoolbytes.education/auth/login>

The screenshot shows the 'School Bytes' login page. At the top, there is a logo consisting of three stacked blue squares of increasing size, followed by the text 'School Bytes'. Below this is the heading 'Log in to the parent portal' and a link 'Or create a new account'. The main form area contains two input fields: 'Email address' and 'Password'. Below the 'Email address' field is a checkbox labeled 'Remember me'. To the right of the checkbox is a link 'Forgot your password?'. At the bottom of the form is a large blue button labeled 'Log in'. In the bottom right corner of the page, there is a link 'User guides' with an external link icon.



## 2. Select the statement of account icon

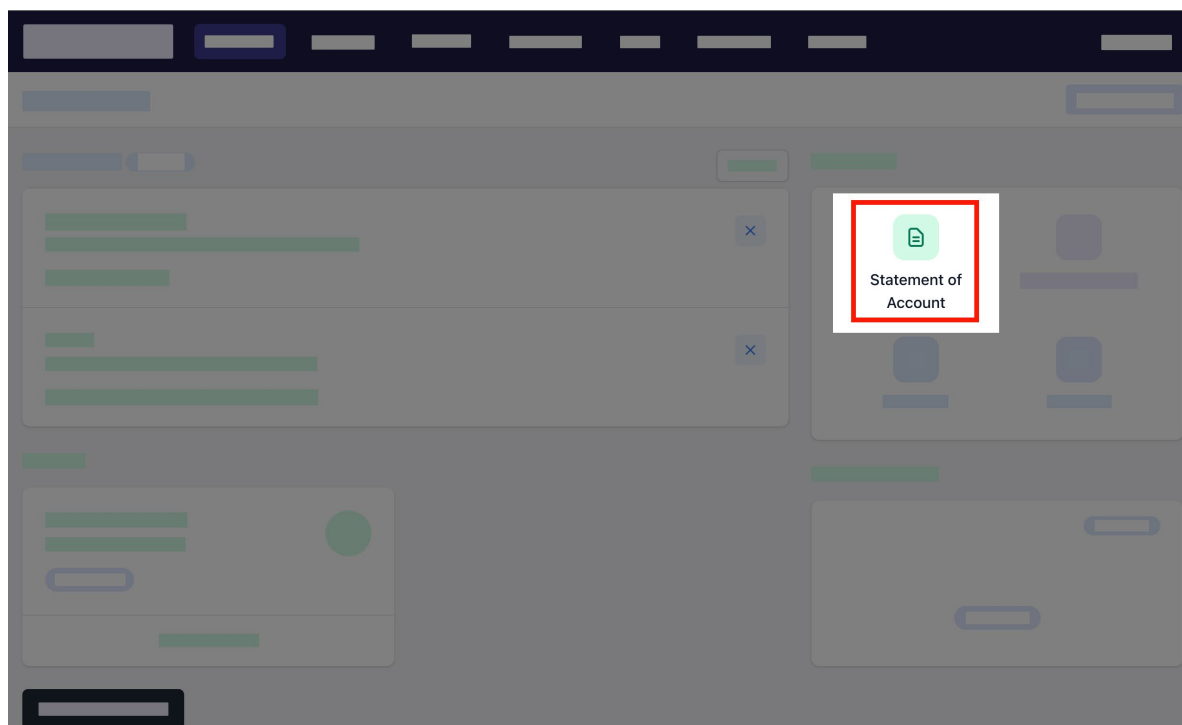

## 3. Select the charges to pay

By default, all the students linked to your account will be displayed, select a student's name to view the charges linked with that student. If the charge is related to an activity consent must be given before making payment.

A screenshot of a web application showing a table of charges. The table has a selection column on the left, which is highlighted with a red rectangular box. The table contains several rows of charges, each with a selection checkbox, a description, and three monetary values. The charges are listed as follows:

<input checked="" type="checkbox"/>				
<input checked="" type="checkbox"/>	Volunteer fee - 12 months	Added: 12/07/2022	\$150.00	\$50.00 \$ 100.00
<input checked="" type="checkbox"/>	Volunteer fee - 12 months	Added: 12/07/2022	\$100.00	\$0.00 \$ 100.00
<input checked="" type="checkbox"/>	Volunteer fee - 12 months	Added: 12/07/2022	\$10.00	\$0.00 \$ 10.00
<input checked="" type="checkbox"/>	Volunteer fee - 12 months	Added: 12/07/2022	\$20.00	\$0.00 \$ 20.00
<input checked="" type="checkbox"/>	Volunteer fee - 12 months	Added: 12/07/2022	\$150.00	\$0.00 \$ 150.00
<input checked="" type="checkbox"/>	Volunteer fee - 12 months	Added: 12/07/2022	\$100.00	\$0.00 \$ 100.00
<input checked="" type="checkbox"/>	Volunteer fee - 12 months	Added: 12/07/2022	\$10.00	\$0.00 \$ 10.00
<input checked="" type="checkbox"/>	Volunteer fee - 12 months	Added: 12/07/2022	\$20.00	\$0.00 \$ 20.00
<input checked="" type="checkbox"/>	Volunteer fee - 12 months	Added: 12/07/2022	\$100.00	\$0.00 \$ 100.00
<input checked="" type="checkbox"/>	Volunteer fee - 12 months	Added: 12/07/2022	\$10.00	\$0.00 \$ 10.00



<div> <div></div> <div> <div></div> <div> <div></div> <div></div> <div></div> </div> </div> <div> <div> <div> <div></div> <div></div> </div> <div> <div></div> <div></div> </div> </div> <div> <div></div> <div></div> </div> </div> </div>			
<div> <div></div> <div> <div></div> <div> <div></div> <div></div> <div></div> </div> </div> <div> <div> <div> <div></div> <div></div> </div> <div> <div></div> <div></div> </div> </div> <div> <div></div> <div></div> </div> </div> </div>			
<div> <div></div> <div> <div></div> <div> <div></div> <div></div> <div></div> </div> </div> <div> <div> <div> <div></div> <div></div> </div> <div> <div></div> <div></div> </div> </div> <div> <div></div> <div></div> </div> </div> </div>			
<div> <div></div> <div> <div></div> <div> <div></div> <div></div> <div></div> </div> </div> <div> <div> <div> <div></div> <div></div> </div> <div> <div></div> <div></div> </div> </div> <div> <div></div> <div></div> </div> </div> </div>			
<div> <div></div> <div> <div></div> <div> <div></div> <div></div> <div></div> </div> </div> <div> <div> <div> <div></div> <div></div> </div> <div> <div></div> <div></div> </div> </div> <div> <div></div> <div></div> </div> </div> </div>			
<div> <div></div> <div> <div></div> <div> <div></div> <div></div> <div></div> </div> </div> <div> <div> <div> <div></div> <div></div> </div> <div> <div></div> <div></div> </div> </div> <div> <div></div> <div></div> </div> </div> </div>			
<div> <div></div> <div> <div></div> <div> <div></div> <div></div> <div></div> </div> </div> <div> <div> <div> <div></div> <div></div> </div> <div> <div></div> <div></div> </div> </div> <div> <div></div> <div></div> </div> </div> </div>			
<div> <div></div> <div> <div></div> <div> <div></div> <div></div> <div></div> </div> </div> <div> <div> <div> <div></div> <div></div> </div> <div> <div></div> <div></div> </div> </div> <div> <div></div> <div></div> </div> </div> </div>			
<div> <div></div> <div> <div></div> <div> <div></div> <div></div> <div></div> </div> </div> <div> <div> <div> <div></div> <div></div> </div> <div> <div></div> <div></div> </div> </div> <div> <div></div> <div></div> </div> </div> </div>			
<div> <div></div> <div> <div></div> <div> <div></div> <div></div> <div></div> </div> </div> <div> <div> <div> <div></div> <div></div> </div> <div> <div></div> <div></div> </div> </div> <div> <div></div> <div></div> </div> </div> </div>			
<div> <div></div> <div> <div></div> <div> <div></div> <div></div> <div></div> </div> </div> <div> <div> <div> <div></div> <div></div> </div> <div> <div></div> <div></div> </div> </div> <div> <div></div> <div></div> </div> </div> </div>			
<div> <div></div> <div> <div></div> <div> <div></div> <div></div> <div></div> </div> </div> <div> <div> <div> <div></div> <div></div> </div> <div> <div></div> <div></div> </div> </div> <div> <div></div> <div></div> </div> </div> </div>			
<div> <div></div> <div> <div></div> <div> <div></div> <div></div> <div></div> </div> </div> <div> <div> <div> <div></div> <div></div> </div> <div> <div></div> <div></div> </div> </div> <div> <div></div> <div></div> </div> </div> </div>			
<div> <div></div> <div> <div></div> <div> <div></div> <div></div> <div></div> </div> </div> <div> <div> <div> <div></div> <div></div> </div> <div> <div></div> <div></div> </div> </div> <div> <div></div> <div></div> </div> </div> </div>			
<div> <div></div> <div> <div></div> <div> <div></div> <div></div> <div></div> </div> </div> <div> <div> <div> <div></div> <div></div> </div> <div> <div></div> <div></div> </div> </div> <div> <div></div> <div></div> </div> </div> </div>			
<div> <div></div> <div> <div></div> <div> <div></div> <div></div> <div></div> </div> </div> <div> <div> <div> <div></div> <div></div> </div> <div> <div></div> <div></div> </div> </div> <div> <div></div> <div></div> </div> </div> </div>			
<div> <div></div> <div> <div></div> <div> <div></div> <div></div> <div></div> </div> </div> <div> <div> <div> <div></div> <div></div> </div> <div> <div></div> <div></div> </div> </div> <div> <div></div> <div></div> </div> </div> </div>			
<div> <div></div> <div> <div></div> <div> <div></div> <div></div> <div></div> </div> </div> <div> <div> <div> <div></div> <div></div> </div> <div> <div></div> <div></div> </div> </div> <div> <div></div> <div></div> </div> </div> </div>			
<div> <div></div> <div> <div></div> <div> <div></div> <div></div> <div></div> </div> </div> <div> <div> <div> <div></div> <div></div> </div> <div> <div></div> <div></div> </div> </div> <div> <div></div> <div></div> </div> </div> </div>			
<div> <div></div> <div> <div></div> <div> <div></div> <div></div> <div></div> </div> </div> <div> <div> <div> <div></div> <div></div> </div> <div> <div></div> <div></div> </div> </div> <div> <div></div> <div></div> </div> </div> </div>			
<div> <div></div> <div> <div></div> <div> <div></div> <div></div> <div></div> </div> </div> <div> <div> <div> <div></div> <div></div> </div> <div> <div></div> <div></div> </div> </div> <div> <div></div> <div></div> </div> </div> </div>			
<div> <div></div> <div> <div></div> <div> <div></div> <div></div> <div></div> </div> </div> <div> <div> <div> <div></div> <div></div> </div> <div> <div></div> <div></div> </div> </div> <div> <div></div> <div></div> </div> </div> </div>			
<div> <div></div> <div> <div></div> <div> <div></div> <div></div> <div></div> </div> </div> <div> <div> <div> <div></div> <div></div> </div> <div> <div></div> <div></div> </div> </div> <div> <div></div> <div></div> </div> </div> </div>			
<div> <div></div> <div> <div></div> <div> <div></div> <div></div> <div></div> </div> </div> <div> <div> <div> <div></div> <div></div> </div> <div> <div></div> <div></div> </div> </div> <div> <div></div> <div></div> </div> </div> </div>			
<div> <div></div> <div> <div></div> <div> <div></div> <div></div> <div></div> </div> </div> <div> <div> <div> <div></div> <div></div> </div> <div> <div></div> <div></div> </div> </div> <div> <div></div> <div></div> </div> </div> </div>			
<div> <div></div> <div> <div></div> <div> <div></div> <div></div> <div></div> </div> </div> <div> <div> <div> <div></div> <div></div> </div> <div> <div></div> <div></div> </div> </div> <div> <div></div> <div></div> </div> </div> </div>			
<div> <div></div> <div> <div></div> <div> <div></div> <div></div> <div></div> </div> </div> <div> <div> <div> <div></div> <div></div> </div> <div> <div></div></div></div></div></div>			



## 6. Select Pay Now

A screenshot of a payment interface. The interface is divided into two main sections. The left section contains several horizontal bars, likely representing a list of items or a progress bar. The right section contains a summary of the payment, including a total amount of \$50.00 and a 'Pay Now' button. The 'Pay Now' button is highlighted with a red box.

## 7. Optionally select pay with saved card

This option will only appear if you have previously saved a credit card.

A screenshot of a payment interface. The interface shows a 'Pay with saved card' option, which is highlighted with a red box. Below this option, there is a dropdown menu showing 'Visa \*\*\*\* \* 1111'. The interface also includes a 'Pay Now' button and a 'Pay with saved card' button.



## 8. Review payment details

If this is your first time making an online payment you will be given the option to 'Save card details for future payments'.

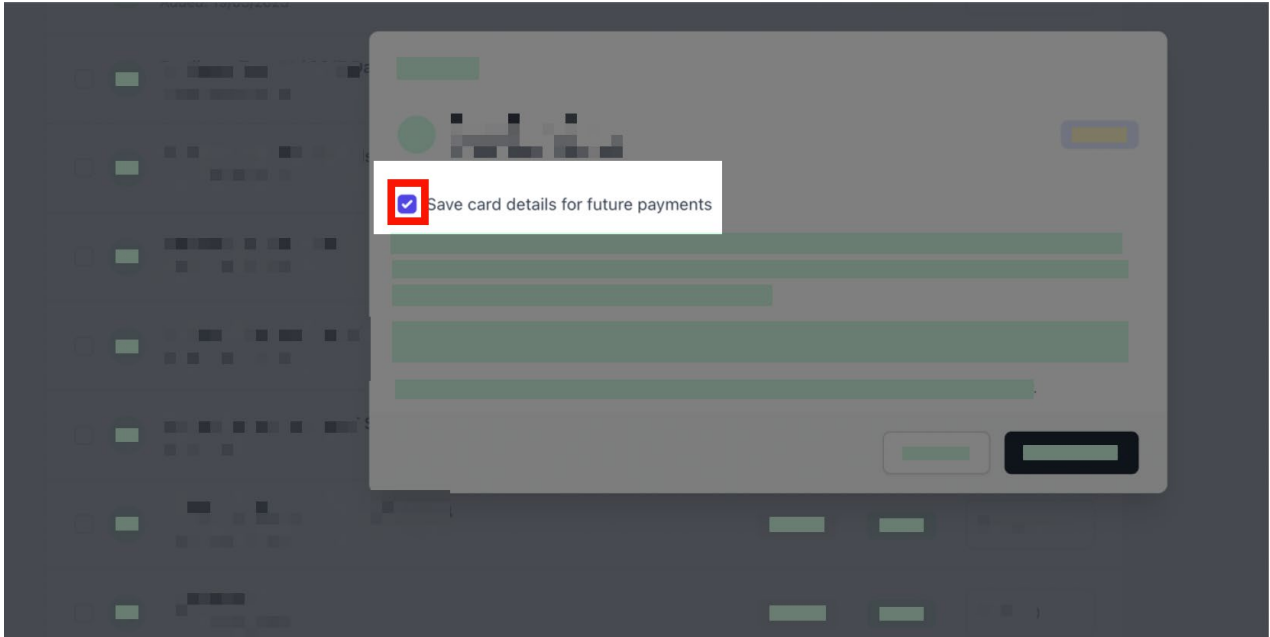

*Optional steps if you choose to save your card details*

## 9. Select pay

You will be redirected to a secure Service NSW payment page to enter your credit/debit card details to finalise payment.

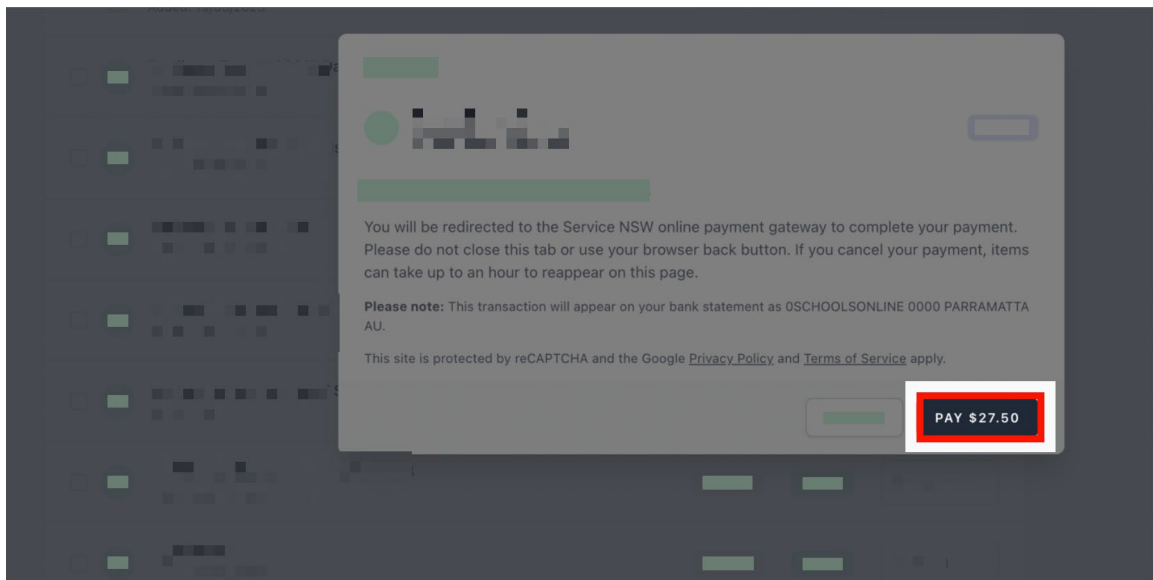

## 10. Payment Successful

Click anywhere outside of the receipt prompt to return to the parent portal. A receipt will be automatically emailed to you. For further assistance, please contact the school on (02) 9823 1033.



# School Map

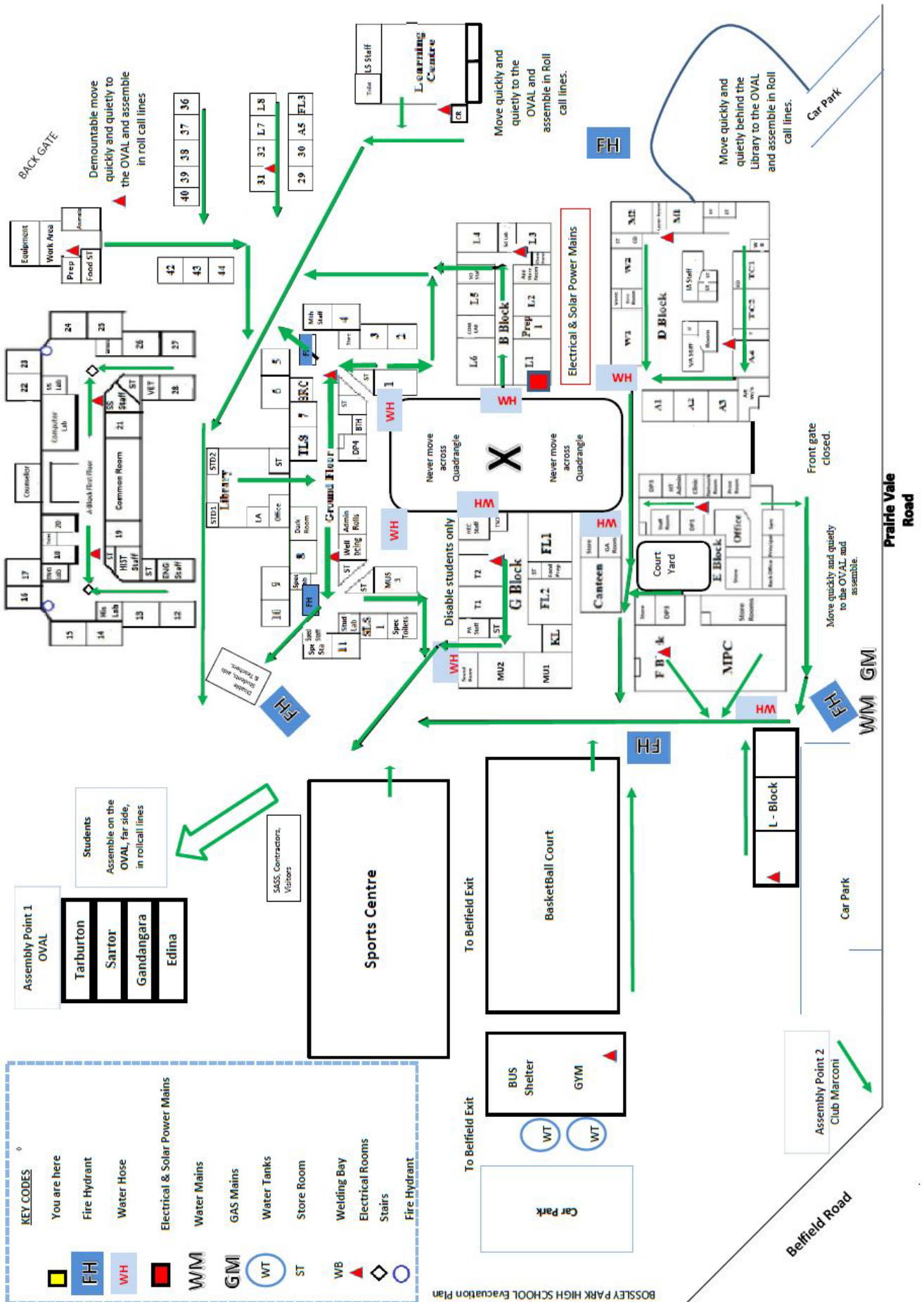



# Parent and Carer Information

Bossley Park High School welcomes Community Participation in the school. The community includes students, teaching staff, the executive, support staff, parents, interested community members, local industry and teachers of support programs. The school community is invited to participate through numerous meetings and school events, such as outlined below:

## Community Support Group (CSG)

This group encourages all parents to be involved and informed in the decision making of the school. CSG Meetings are held at Club Marconi upstairs conference room at 6pm typically on a Monday. Dates and times are confirmed via email and school website updates to parents. Please look out for correspondence relating to CSG meetings throughout the year. Curriculum issues are discussed at most meetings. Every student in their school charges, is invoiced a \$2 CSG levy which goes towards fundraising.

## School Website

<https://bossleypk-h.schools.nsw.gov.au/>

## School Newsletter 'Bossley Biz'

A school newsletter is issued electronically via email and social media or accessible from the school's website. Current and past newsletters are readily available on the school's website. Our school newsletter and website provide valuable information for both parents and students.

## Social Media

Facebook: BPHS Wellbeing

Twitter (X): bossleyparkhs

Instagram: bossleyparkhs

## School Bytes

Bossley Park High School uses School Bytes for financial payments including fees/levies and excursions. Parents will receive family statements with a link to Parent Online Payments via email. Excursion notes may also be emailed to you with links to payment. School Bytes allows for instalments or full payments to be made. If you do not have an email, you will receive your statement in the mail.

## Reports – Parent/Teacher Interviews

The school issues two reports to parents/guardians each year. School reports are issued twice a year at half yearly intervals. Parents make appointments to see their child's teachers with an online booking service on the Sentral Parent Portal System. Login details are provided to parents closer to Parent/Teacher evening dates.





# Frequently Asked Questions

## What do I do when I arrive at school?

Move to and remain in the playground. You are not to remain near the entrance gate, leave the school or use the school oval before school.

## What do I do if I'm sick?

Your parent/carer will need to respond to the SMS sent to his/her mobile or bring in a note from parent/carer the next day. If you are absent from school for two or more consecutive days a Doctors Certificate is required.

## What do I do if I'm late?

All students who arrive late (after the period one start bell) **MUST** report to the school administration front office to collect a late arrival slip. These students will be marked as a **PARTIAL** absence for the day. All students must provide a signed note by a parent with a valid reason, "Slept in and traffic" will not be accepted. Students must show the late arrival slip to their period one class teacher on the day. (*This is to avoid any discrepancies*). Students with high rates of lateness to school will have consequences. These students may be required to report to the Principal, Deputy or HT Administration to be given a clean-up duty, lunch detention or senior students may be required to stay back on Thursday period 4 also.

## What do I do if I need to leave early?

Application for an early leavers pass can only be made prior to period 1 each day. A letter from your parent/carer stating the following must be supplied – Your name, year, roll call, date, time, reason and a mobile contact number to verify requests. Parents/carers are reminded that all students are to be signed out and picked up via the school administration office. If your year 12 child is required to catch the bus, walk or drive themselves to their destination, it must be clearly stated on the permission note. (**Notes can be found in the purple Student Absentee Booklet**). This letter must be placed in the box outside the Head Teachers Administration Office labelled Attendance Box, prior to period 1 each day. Early Leaver passes can be picked up at recess from the Head Teachers Administration Office door. Students are to exit the school via the School Administration Office presenting the pass to be verified.

## What do I do if I am absent from school?

Students must bring a note in on the very next day. If you are absent for 2 or more consecutive days a Doctors Certificate is required. The note must have the date/s, reason and a parent/carer signature.

Parents are advised to use the **Purple Student Absentee Booklet** provided by the school. They contain a section for your own records and the note that your child gives to their roll call teacher upon return from an absence. The booklet can also be used for a student's early leaver pass or lateness to school pass. **All parents are notified of their child's absences (whole and partial) each day via SMS.** *If your email address or mobile contact for SMS is not recorded with the school, please contact the school administration office on 9823 1033 and provide your current details.*

Attendance rates are monitored regularly. Bossley Park High School is known for its high expectations towards attendance. Students with poor attendance rates- ie below 90% will be interviewed by Head Teacher Administration, Year Advisers and the Home School Liaison Officer (HSLO). These students will be put on an attendance card and improvements must be made. Failure to improve will result in an attendance plan monitored by the HSLO. Students who fail to bring in a note explaining their absences will be reminded by their roll call teacher.

Lunchtime detentions may be issued for repeat offenders. If a student is absent for **three or more consecutive days** parental contact will be made by Head Teacher Administration.





## What do I do if my family is planning a holiday?

Bring in a note from your parent/carer to explain the circumstances, eg: where you are going, the dates of your leave and the reason for your trip, to the school administration office. This note needs to be handed into the school administration office; you may be called upon to provide further information. On return to school, check with your teachers what work you have missed and catch up on this work.

**Extended leave must be approved by the principal.**

## What do I do if I have a uniform issue?

Bring a note in from your parent/carer explaining the reason for not wearing the correct uniform items and give it to your deputy principal before school. Your deputy principal will issue you with a uniform pass.

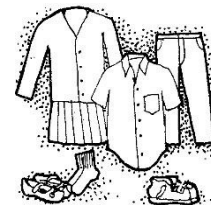

## What do I do if I am sick or injured at school?

You need to notify your nearest teacher. You do **not** contact your parents by phone.

The teacher will issue you with an 'out of class pass' and you are to report to the Deputy. You will then report to the school administration office where first aid can be administered, or parents can be contacted to collect you from school.



## What if I need to take medication at school?

All students who need to take medication while at school should leave the medication with the school administration office. A letter needs to accompany the medication explaining the reason for the medication and the dosage required and times.



## If you are late between classes

You must have a note from your previous teacher explaining the reason why you are late to the next class.

## If your parents need to drop something off for you at the school

All visitors are to report to the school administration office. parents/carer/friends are not to go into the school grounds and approach students. Items brought to the school administration office for students must be clearly labelled with the student's name. If you know your parents are dropping off something for you, please collect from the school administration office during your break times.



## If you are leaving/transferring school

You must bring in a note from your parents to the principal indicating your new address, new school or occupation if you are leaving. You will be given a leavers form from the school administration office. This form should be taken to your teachers and Deputy Principal for completion. You must return all textbooks, library books, school equipment, bus passes and pay any outstanding fees.



## How do I make a payment and/or attend an excursion?

Payments can be made through the online "Parent Online Payment" system (accessible from the school's website – click on "Communities – "Make a payment"). You could also make payments at the school administration office. Payment and note must be submitted by the due date. Students may make payments before school, recess or lunch in the school administration office. EFTPOS and credit card facilities are also available. *Any student causing concern in the school may not be allowed to attend excursions. Misbehaviour whilst on an excursion will be dealt with severely. It may prevent you attending excursions in the future and/or result in the loss of other school privileges.*

 **Make a payment**



## If you have lost personal property

All clothing and equipment should be marked with indelible ink to show the owner's name and roll class. Money, watches and wallets should not be left in clothing or school bags, at PE or sport. Care for valuables is the student's responsibility. Valuables should not be left unattended at any time. Students are not to bring electronic games, IPODs and mobile phones to school. These will be confiscated, and parents notified. Lost property is handed in at the school administration office or the lost property area (near Disability Support Unit)

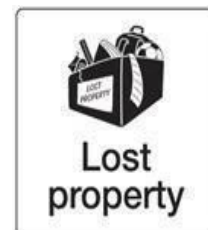

## I have lost my timetable.

Please see your Deputy to obtain a reprint (\$1 charge for reprint).

## Is there a used uniform shop?

Pre-loved school uniform clothing is available for purchase. Please see the school administration office for more information and purchase.

## What if you need to contact your parents?

See a Deputy Principal – mobile phones should not be used.



## If you wish to purchase from the canteen before school, during recess and lunch

Pushing in or asking others to buy your food is unacceptable behaviour. Stay in line, moving up to the window when it's your turn. Only buy for yourself. Students are not to use the canteen between periods or during lesson time. Lunch order can be made before school or at recess.

## If you change address or details

It is vital that we have accurate up to date information on all students, particularly in emergency situations. If a change occurs throughout the year, contact the school immediately.

Any change of address, phone number or other essential information should be supplied to the school administration office in writing or email to the school's email address.

[bossleypk-h.school@det.nsw.edu.au](mailto:bossleypk-h.school@det.nsw.edu.au) – clearly stating your child's name and class.





# Saturday School

**Enrol Now!**  
Available to all High School Students  
(Government and Non-Government Schools)



**The Saturday School  
of  
Community Languages**



**Free**, Board of Studies Accredited Courses Year 7 to HSC  
Qualified Teachers – Approved by DEC

Bengali Hindi Khmer Polish  
Serbian Spanish (to Extension level)

<http://www.sscl.schools.nsw.edu.au>



**Liverpool Girls' High School Centre**  
Forbes Street, Liverpool. Ph/Fax 9822 5423 (Saturdays)



Enquiries during the week: 9244 5315





**Saturday School of  
Community Languages**

Studying a background community language:

- provides an opportunity to develop high levels of skills in a student's background community language
- improves performance across the curriculum through enhanced literacy skills which are transferable to English
- helps maintain rewarding relationships with parents, grandparents, relatives and other community members
- promotes a sense of cultural identity resulting in heightened self-confidence and self-esteem
- places students in a better position to take advantage of employment opportunities

*Developing students' knowledge and skills in their background language*

[www.sscl.schools.nsw.edu.au](http://www.sscl.schools.nsw.edu.au)

Contact your local centre on 9822 5423