



Student Information Booklet 2023

School Song

Verse One:

We are a school called Bossley Park High,
Where we learn and where we strive;
With our teachers to do our best,
Focussing on excellence and success.

Chorus:

Goodness is symbolised through
Our black and white colours.
We're always there to lend a helping hand to others.
Multicultural races harmonise to fill the halls,
So it's plain to see, the place to be
Is behind our Bossley walls.

Verse Two:

Teachers and students working as one,
Through years of achievement,
To get things done;
In an environment of prosperity,
Bossley Park High is the place to be.

Go back to **CHORUS**



Contents

School Song	2
Contents	3
School Information	4
Principal's Message	5
About The School	6
Bell Times	7
Executive Team	8
Year Advisers	10
Student Wellbeing	11
School Support Teams	13
Student Representative Council (SRC)	14
School Captains and Vice Captains	14
House System	15
Student Leadership Teams	16
Staff List	17
Important Uniform Requirements	18
Attendance	19
High Potential and Gifted Program	21
Robotics	25
Bring Your Own Device (BYOD)	26
Core Rules	27
Core Values	28
School Safety	29
Mobile Phone Policy	30
Merit System	31
PBL Reward System	33
School Library	34
Agriculture	35
Disability Support Unit	36
Careers	37
Curriculum	38
Charges & Administration Costs	40
Statement of Account – Online Payments	42
School Map and Evacuation Plan	44
Parent and Carer Information	45
Frequently Asked Questions	46

School Information

Contact Details:

Address: 36-44 Prairievale Rd Bossley Park 2176

Phone: (02) 9823 1033 Fax: (02) 9823 7835

Email: bossleypk-h.school@det.nsw.edu.au

Website: <https://bossleypk-h.schools.nsw.gov.au>

Facebook: <https://www.facebook.com/BPHSWellbeing/>

Twitter: [twitter@BossleyHS](https://twitter.com/BossleyHS)

Instagram: @bossleyparkhs

School Administration Office Hours: 8:05am – 3:15pm

Parent/Student portal - <http://web1.bossleypk-h.schools.nsw.edu.au/portal/login>

Director Public Schools NSW - Cowpasture Network

Marianne Siokos – Campbelltown Education Office - 4633 2700

Community Support Group (CSG):

CSG meetings are held in the Learning Centre at 6.30pm on the third Tuesday of each month during the school term. The first meeting will be held on Tuesday 21st February 2023.

All parents are welcome to attend.

Bus Information:

Transit Systems: (02) 8778 5800 or www.transitsystems.com.au



Principal's Message

Welcome to Bossley Park High School

Bossley High Park School offers a wide range of teaching and learning programs. Our comprehensive curriculum provides many opportunities for all students to engage and thrive in a diverse learning experience. At Bossley Park High School, we aim to have students build positive connections within the school community and make them feel known, valued and cared for.



The school is recognised for its very broad curriculum including high potential and gifted programs. Extensive extra-curricular activities allow students to excel in sporting and cultural pursuits and opportunities for participation and development in leadership are provided. Additionally, our afterschool tutoring provides students with further support in their learning.

Bossley fosters a culture of high expectations for staff and students. We are committed to ensuring students are Safe, Respectful Learners and maintain correct uniform standards. A key focus area of this is to unearth student talent and develop their potential.

The school provides alternate educational opportunities that are offered by TAFE, school-based apprenticeships and traineeships, and community agencies in order to provide a variety of educational pathways that cater for individual needs and aspirations. An important feature of our school is the support that is offered to each child, with special programs addressing the learning requirements of students with specific needs.

At Bossley Park High School, we promote that all students have a right to learn and a responsibility to learn. We are a 'Positive Behaviours for Learning' school and promote this as a foundation block in our school culture. We are well known in the community for our strong wellbeing initiatives and comprehensive discipline policy which support all students in their development as an individual and as a student, so their potential is realised.

We have a strong commitment to maintaining an attractive school environment and providing excellent facilities. We promote and have maintained strong community support with parents playing an active and supportive role in the school.

To ensure high quality teaching and learning and improved student outcomes at Bossley Park High School, we are committed to ongoing professional development of all staff. We value and foster staff morale and cohesion by acknowledging and valuing the work of all staff, their commitment and achievements.

Through high quality teaching and learning programs, a comprehensive discipline policy and wellbeing initiatives that promote student leadership, resilience and responsibility for learning, we aim to develop students who can confidently meet the challenges of the future and take their place as responsible citizens.

Reece Hooke
Relieving Principal

About The School

Bossley Park High School is built on land that was formerly farm lets, producing vegetables, flowers and poultry products.

The first student intake of the school entered Year 7 on 2nd February, 1988. Our students are largely drawn from the neighbouring primary schools - Governor Phillip King Public School, Bossley Park Public School, Prairievale Public School and Edensor Park Public School. Amongst our enrolment are some students with physical disabilities.



The school colours are black and white. The crest was designed in 1987 by Mr Lance Hopper, a Visual Arts teacher at Grantham High School. The school flag was designed in 1991 by one of our Year 8 students, Cynthia Sciuto.

Each student belongs to a House. The House groupings are mainly for student roll call, though there is a House sporting competition. The four Houses are Edina (green), Gandangara (yellow), Sartor (red) and Tarburton (blue).



Bell Times 2023

ALL YEARS 7 – 12

PERIOD	MONDAY ONLY- (LATE START)	TUES, WED, THURS AND FRI
<i>Warning</i>	9.17am	8.37am
1	9.20am	8.40am
RECESS 1	10.00am	10.00am
2	10.15am	10.15am
RECESS 2	11.35am	11.35am
3	11.50pm	11.50pm
LUNCH 1	1.10pm	1.10pm
LUNCH 2	1.25pm	1.25pm
4	1.40pm	1.40pm
END OF SCHOOL DAY	3.00pm	3.00pm

Evacuation: It is an emergency if there is a **CONTINUOUS** ringing of the bell. If this occurs, the building must be evacuated **IMMEDIATELY**.

Staff and students are required to move quickly but safely to the **SCHOOL OVAL**.

Lockdown: Is signalled by 12 or more consecutive rings of the bell. Classes remain in place. Check corridor and have unsupervised students enter. Mark roll then conduct lesson until further notice or all clear.

School Terms 2023

Term 1 – Tuesday 31st January 2023 – Thursday 6th April 2023

Term 2 – Monday 24th April 2023 – Friday 30th June 2023

Term 3 - Monday 17th July 2023 – Friday 22nd September 2023

Term 4 - Monday 9th October 2023 – Tuesday 19th December 2023

Executive Team

Relieving Principal
Reece Hooke



Deputy Principal
Years 7 & 11
Mr R Navarra



Deputy Principal
Years 8 & 12
Ms A Ager



Deputy Principal
Year 9
Mr S Vasiliou



Deputy Principal
Year 10
Mr D Foti



Business Manager
Ms A Ligorì



**Head Teacher
Administration**
Mr P Riddle



**Head Teacher
Administration**
Ms J Dundovic



**Head Teacher
Secondary Studies**
Ms K O'Connor



**Head Teacher
Teaching&Learning**
Ms M Cassin



**Head Teacher
Teaching&Learning**
Mr L Vacarro



**Head Teacher
Teaching&Learning**
Ms A Matic



**Head Teacher
Wellbeing**
Mr N Zantiras



Executive Team

**Head Teacher
English**
Ms J Yalda



**Head Teacher
Mathematics**
Ms S Sampol



**Head Teacher
Science**
Ms S Pham



**Head Teacher
History**
Ms K Curic



**Head Teacher
Social Science**
Ms V Kokokios



**Head Teacher
Visual Arts**
Ms Z Iaali



**Head Teacher
Industrial Arts**
Mr J Agostino



**Head Teacher
PDHPE**
Mr D Gaziler



**Head Teacher
Performing Arts**
Ms M Lopez



**Head Teacher Home
Economics**
Ms E Taylor



**Head Teacher
Disability Support**
Mr S Viravong



**Head Teacher
Learning Support**
Ms L Roby



Year Advisers

Year 7
Ms J Zeatier



Year 7
Mr J Lepore

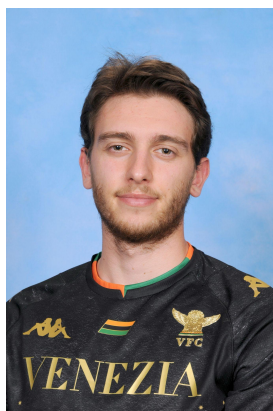

Year 8
Ms S Tarar



Year 8
Ms L Tran



Year 9
Ms E Ulbrand



Year 9
Ms L Coleman



Year 10
Ms F Weir



Year 10
Mr J Bian



Year 11
Ms B Luong



Year 11
Mr A Moser



Year 12
Ms A Pabiona



Year 12
Mr J Frech



Student Wellbeing

The role of the Wellbeing Team

- supporting the Wellbeing needs of students at Bossley Park High School
- seeking solutions to wellbeing problems, both general and individual
- referring wellbeing problems to specialist services or agencies, where appropriate
- reviewing, writing and implementing wellbeing policies
- ongoing evaluation of policies and procedures
- communicating with and providing guidance for staff
- maintaining consistency throughout the school
- initiating and coordinating staff development in wellbeing strategies and procedures
- communicating with parents regarding wellbeing issues
- monitoring student progress through semester reports, progress reports and the online system
- coordinating activities and implementing programs to support the wellbeing needs of students
- meeting fortnightly to facilitate the above



Mr N Zantiras

The role of the Counsellors

School Counsellors are employed by the Department of Education to assist students with a variety of educational, social and emotional issues. They can provide a number of services, including individual psychological assessments, counselling, educational assessments and assistance for students with special needs. School Counsellors work closely with the School Executive, Student Advisers, Careers Adviser, The Learning Support Team and other staff to help individual students achieve their goals. They also provide a link between feeder primary schools and Bossley Park High School, enabling a smoother transition into high school for many Year 7 students.

Our school counsellors are Ms Julianne Dimaano and Ms Shirley Lu. The counsellors may be contacted Monday-Friday during school hours. Students needing support out of school hours should call the Kids Helpline 1800 551 800 or Lifeline 13 1114. Miss Orhai Barkho has a background in reinforcing the wellbeing, welfare and learning outcomes of young people, families and those of refugee background. Miss Barkho is located in the Clerical Office on the ground floor of A Block (across from the Library). Student Support Officers (SSO) work within the school community in partnership with the learning and support team and school counselling service to enhance student social and emotional wellbeing and learning outcomes. SSO provide both whole-of-school wellbeing initiatives and targeted strengths-based supports for students requiring personalised assistance. They also have a pivotal role in working collaboratively with external child and family support agencies and other government agencies to support students.

Student Support Officer

Ms O Barko



School Counsellor

Ms J Dimaano



School Counsellor

Ms S Lu



YOUR MENTAL HEALTH MATTERS

Getting support at school

Sometimes life can be difficult. Stress, anxiety and feeling down can affect anyone, and quite often happens to a lot of us at some point in our lives. We all have good and bad days. However, if you're feeling sad, down or anxious and these feelings have started to affect what you would normally enjoy or do, then it's important to find out what's going on and what you can do about it.

Who you can talk to...

You can speak with one of the School Counsellors at Bossley Park High School. There are two School Counsellors who work at the school. Julianne Dimaano who works on Mondays, Wednesdays and Thursdays and Shirley Lu who works on Tuesdays and Fridays. School Counsellors can help anyone who is experiencing difficulty with:

- Anxiety
- Anger
- Body Image
- Self-Esteem
- Bullying
- Family
- Grief and Loss
- Identity and Gender
- Stress
- Etc



How you can access the School Counsellors...

You can either self-refer or speak to one of your Year Advisers and they can refer on behalf of you.

You can also speak to a trusted staff member such as your Year Adviser or request to see the Student Support Officer, Orhai Barkho at Bossley Park High School via your Year Adviser.

Getting support after hours...

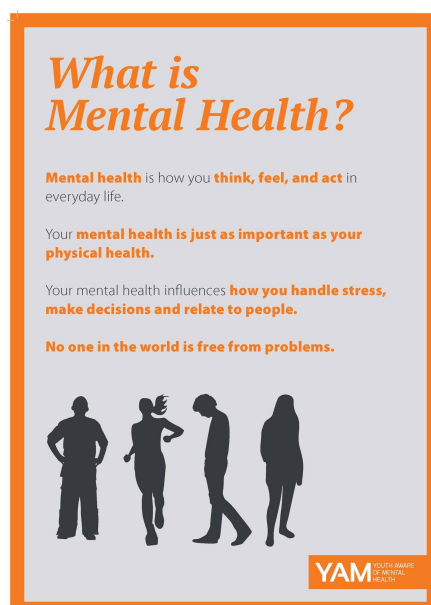

School Support Teams



Ms L Roby
HT Learning Support



Ms K Matutina
Learning Support



Mr D Nguyen
Learning Support



Mr J Bian
EAL/D

Learning Support - The Learning Support faculty consists of specialist teachers whose main function is to assist students with their individual learning needs. In any one school there will be students who experience difficulties with learning. This could be because of the way they learn, the rates at which they learn or having second language learning barriers. These difficulties can also vary in cause, nature, intensity and/or duration. Within the faculty, there are Learning and Support teachers, English as an Additional Language/Dialect (EAL/D) teachers and School Learning Support Officers. Each staff member brings with them a wealth of knowledge and experience that benefits the well-being and learning of students in their care. We assist in the transition of students with additional needs including; primary to high school transition, cross-school transition and school to work transition. In addition to this, faculty staff members work with teachers from across the school and with a wide range of external agencies and specialists, in order to best support the learning needs of the students at Bossley Park High School.

International Students – Bossley Park High School offers a range of academic, welfare and engagement programs for International students. Working closely with the International student co-ordinator, International students' academic and welfare needs are monitored and catered for, as well as ensuring that they are abiding by the conditions of their visa. Along with developing their English language and literacy knowledge and skills, students are encouraged to take part in the social and wellbeing activities at the school, in extra-curricular activities and be active contributors to the school community.

Refugee Students – Bossley Park High School has a dedicated program of support for students who are identified as being refugee or have refugee-like experiences. Ranging from ensuring that new students settle in school and learning, additional language and literacy support, welfare and wellbeing monitoring and dedicated classes taught by specialist teachers; students with a refugee background are supported to ensure academic and wellbeing success. Working with Western Sydney University, the school runs the Refugee Action Support (RAS) Program whereby student teachers work closely with small groups of targeted refugee students to further develop their English language and literacy skills through KLA subjects.

Aboriginal Students – Bossley Park High School is committed to closing the achievement gap for Aboriginal students. We know that we need to learn about, nurture and value the cultural identity of our Aboriginal students in order to assist them to be successful learners. We welcome Aboriginal and Torres Strait Islander family members, parents and community members to our school so that we can get to know each other, learn about the local Aboriginal community and develop shared goals and plans for Aboriginal students.

A key component of Aboriginal Education at Bossley Park High School is to ensure that our teachers and students have a thorough understanding of Indigenous issues and that Aboriginal students are working at levels comparable to - or better than - their school and state cohort. The Bossley Park High School Aboriginal Education Committee work in partnership with the Fairfield AECG and meet regularly to coordinate activities and support the learning and engagement of our Aboriginal students.

Student Representative Council (SRC)

The role of the SRC

The SRC represents the students of the school. The group is comprised of 6 students per year group (7-12) as well as the four School Captains. The SRC have fortnightly meetings where an agenda is discussed, such as fundraising, volunteering and other ideas to help benefit the students at BPHS. School Captains are invited to a "Captains Lunch" with the Principal where matters are discussed to benefit all involved at BPHS. The Student Representative Council are encouraged to listen to their peers and voice any suggestions or issues within the school at the appropriate meetings to be discussed.



Ms S Volpe



Ms L Grujovski

School Captains and Vice Captains

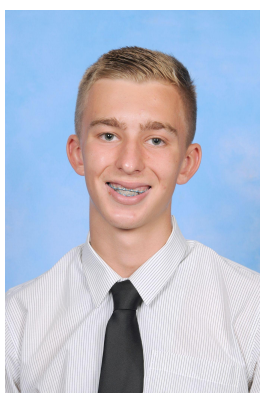

School Captain
Owen Wilson



School Captain
Jessica Tran



Vice Captain
Hannah Petrella



Vice Captain
Franceso Cassarino

The position of School Captain is a respected role that involves considerable responsibility and initiative. Captains are the leaders of the student body, and as such are role models for the students of Bossley Park High School. Exemplary conduct, presentation and fulfilment of duties are required at all times. School Captains and Vice Captains will:

- Complete leadership training
- Officiate at functions
- Speak confidently and expressively at assemblies and other school events such as hosting Performance Evening
- Represent the interests of the Bossley Park High School student body
- Demonstrate leadership and be a role model for junior members of the SRC
- Attend and lead regular SRC meetings and take an active role in student representation of the school and in the community
- Demonstrate initiative and creativity in leading SRC priorities within the school
- Liaise with teachers, Deputies and the Principal on matters of importance to the students
- Organise and attend regular meetings with the Principal and CSG

House System

Students will be allocated a House according to the alphabetical order of family names for vertical rolls and the promotion of house spirit.

EDINA	GANDANGARA	SARTOR	TARBURTON
-------	------------	--------	-----------



The role of the House Captains and House Vice Captains

The position of House Captain and Vice House Captain is a respected role that involves **considerable responsibility and initiative**. House Captains are the house and sport leaders of the student body, and as such are **role models** for the students of Bossley Park High School.

House Captains and Vice-Captains will:

- Attend regular House Captain meetings;
- Join the school's Interact club, and develop and work on projects to help the school and community;
- Act as role models and leaders for students from their houses in all school activities;
- Be active participants in the full range of House activities;
- Organise and lead student teams at school swimming, cross country and athletics carnivals;
- Motivate and encourage students within their houses to participate in school swimming, cross country and athletics carnivals;
- Participate in Year 7 orientation days and activities;
- Always demonstrate exemplary presentation and conduct so as to provide strong leadership and guidance for the members of their House.



Student Leadership Teams

Interact Club

Bossley Park High School's Interact Club has been giving students the opportunity to make a real difference in the school and community. Our Interact Club meets once a fortnight before school to discuss ways in which students can assist the school and the community.

As part of the Interact Club, students are given the opportunity to:



Ms A Melville

- connect with community leaders
- develop leadership skills
- make international connections
- discover more opportunities to connect with Rotary, including Rotaract, and Youth Exchange
- encourage the school and community to make a difference



In the past year, the Interact Club has contributed over \$3000 in funds to various causes. Some of the causes that the Interact Club have been involved in include: Beanies for Brain Cancer, Relay for Life, BCNA's Pink Bun Day, Jeans for Genes Day, Harmony Day, Carols at Horsley Park and many more.

Interact Club members have also attended numerous Leadership and Team-building Conferences that gives them the opportunity to network with other Interact Clubs in the district, explore ways of more effectively campaigning to support worthy causes, develop their confidence to lead and manage, and fundraise more effectively in the school and in the community. The Interact Club is a great place to meet students from different schools and develop the essential communication, teamwork and leadership skills needed to succeed in the 21st Century. See what our Interact President has to say!



Amy Vu (Interact Club President)

Growing up, I've always wanted to give back to the general community and in 2019 I was able to do that by joining the Interact Club. The Interact Club instantly became a place where I can freely express my ideas and work with other people, to assist others, in order to change and contribute to the improvement of the world, for a better place for all individuals and communities.

Becoming President of the Interact Club in 2020, extended my knowledge of different perspectives and ideas of individuals due to the opportunities given to me. These opportunities allowed me and many other members to become more involved with the school and the wider community.

I truly believe that my membership in the Interact Club significance builds my confidence. In addition to this, I am able to learn new skills like leadership and teamwork along with other members, which motivates me to be dedicated to my goals of helping others, to contribute and make a difference in this world. It impacted my life, by giving me countless opportunities and experiences in helping others.

Staff List 2023

<p>PRINCIPAL</p> <p>Mr R Hooke (Rel)</p> <hr/> <p>DEPUTY PRINCIPALS</p> <p>Mr D Foti – Yr 10 Mr R Navarra – Yr 7 & 11 Ms A Ager – Yr 8 & 12 Mr S Vasiliou – Yr 9</p> <hr/> <p>ENGLISH</p> <p>Ms J Yalda - HT Rel Ms L Grujovski - SRC Coord Ms L Hodge Ms A Melville Ms K O'Connor – HT Secondary Studies Ms A Pabiona – Yr 12 Adviser Ms L Tran Ms K Weeks Mr C Maia Ms K Simic Ms J Zeaiter - Yr 7 Adviser Ms M Cabrera (ISPL- Literacy)</p> <hr/> <p>HISTORY/LOTE</p> <p>Ms K Curic – HT Ms T Jakovljevic Ms A Matic – HT T&L Ms J Dundovic - HT Admin Mr B Clark Ms E Avdicevic Ms P Zallo - Languages Ms M Cabrera - Languages</p> <hr/> <p>HOME ECONOMICS</p> <p>Ms E Taylor – HT Rel Ms S Moiler – VET Coordinator Ms S Powell</p> <hr/> <p>HOME ECONOMICS ASSISTANT</p> <p>Ms E Foti</p> <hr/> <p>INDUSTRIAL ARTS</p> <p>Mr J Agostino - HT Mr V Maharaj Mr S Scott - Robotics Mr M Medcalf</p>	<p>LEARNING SUPPORT & EAL/D</p> <p>Ms L Roby – HT Mr D Nguyen Mr L Simpson</p> <hr/> <p>EAL/D</p> <p>Mr J Bian – Yr 10 Adviser Ms K Rorimpandey</p> <hr/> <p>STUDENT LEARNING SUPPORT OFFICERS</p> <p>Ms K Breski Ms R Martino Mr S Malfara Ms R Safadi</p> <hr/> <p>MATHEMATICS</p> <p>Ms S Sampol – HT Ms E Charbine Mr P Ferraccioli Mr D Huynh – International Students Ms B Luong - Yr 11 Adviser Mr M Nikolich Ms M Pacialeo Mr R Singh Ms L Todic Ms S Trikilis - Robotics Ms S Volpe - SRC Coord Ms G Lee – ISLP Numeracy Mr E Suhartono</p> <hr/> <p>PDHPE</p> <p>Mr D Gaziler - HT Ms T Breski – Sports Coordinator Ms S Leonida Ms D Reid Mr G Stanmore - TFP Ms F Tuffano Mr N Zantiras – HT Wellbeing Ms T Bevilaqua Ms R Ribero Mr J Lepore - Yr 7 Adviser Mr C Thurecht</p> <hr/> <p>PERFORMING ARTS</p> <p>Ms M Lopez – HT (M - Th) Ms S Wais – HT Rel (F) Mr P Riddle – HT Admin Ms E Ulbrand – Yr 9 Adviser Mr S Pagano</p>	<p>SCIENCE</p> <p>Ms S Pham – HT Ms E Dagher Mr B Krishna Mr R Martino Ms L Montalbo Mr M Newton Mr U Reed Mr K Matutina Mr H Pahlow Mr M Wajzer</p> <hr/> <p>LAB ASSISTANTS</p> <p>Ms M Luker Ms K Nieuwenhuizen</p> <hr/> <p>SOCIAL SCIENCE</p> <p>Ms V Kokokios – HT Rel Ms L Vacarro - HT T&L Mr J Frech – Yr 12 Adviser Mr A Pisani Mr A Moser - Yr 11 Adviser</p> <hr/> <p>SPECIAL EDUCATION</p> <p>Mr S Viravong – HT Ms P Jas Ms N Petrovska Mr D DeVier</p> <hr/> <p>STUDENT LEARNING SUPPORT OFFICERS SPECIAL ED</p> <p>Ms M Ruisi Ms M Mediat Mr W Sheba Ms T Borg Ms J Zaccaria / Ms A Nissan</p> <hr/> <p>TEACHING AND LEARNING</p> <p>Mr L Vacarro – HT Ms A Matic – HT Rel Ms M Cassin - HT</p> <hr/> <p>VISUAL ARTS</p> <p>Ms Z Iaali – Rel HT Ms L Coleman – Yr 9 Adviser Ms S Tarar – Yr 8 Adviser Ms K LoBasso Mr T Tan</p>	<p>COUNSELLOR</p> <p>Ms J Dimaano Ms S Lu</p> <hr/> <p>STUDENT SUPPORT OFFICER</p> <p>Ms O Barko Ms A Sari</p> <hr/> <p>CAREERS</p> <p>Ms A Chehade</p> <hr/> <p>LIBRARY</p> <p>Ms F Weir – Yr 10 Adviser</p> <hr/> <p>LIBRARY ASSISTANT</p> <p>Ms K Ferrington-Smith</p> <hr/> <p>ADMINISTRATION</p> <p>Ms L Zappia Ms M Breski Ms C Marfia Ms M Demasi Ms R Di Cristo Ms J Nicolson Ms R Sylvester Ms C Colosi Ms M Supurovic Ms R Thompson Ms K Thompson - CLO</p> <hr/> <p>BUSINESS MANAGER</p> <p>Anna Ligori</p> <hr/> <p>TSO</p> <p>Mr W Bennett – IT Coordinator Mr R Melisi</p> <hr/> <p>MAINTENANCE/GROUND</p> <p>Mr B Marsh Mr N O'Neill</p> <hr/> <p>CANTEEN</p> <p>Afrothiti Hzaife</p>
--	---	---	--

Important Uniform Requirements

School Uniform Code and Procedures

A uniform dress code reinforces students' pride in their own appearance, instils recognition of themselves as an integral part of the school community, and assists in developing pride in representing their school. Issues of equality, expense, and health and safety are also factors that contribute to the establishment of the Uniform Policy.

The school has health and safety regulations which are in accordance with the Department of Education (DoE). These must be followed by all students at all times.

Footwear

- **Fully enclosed all black firm and sturdy leather lace-up shoes must be worn. Not accepted:** buckle-up shoes, ballet-style slip on shoes, suede or soft canvas style sport shoes, no coloured trim or coloured brand logo ankle high basketball-style boots, shoes with a heel greater than 3cms or platforms and boots of the Doc Martens or military style.

Jewellery

- Unacceptable items of jewellery will be confiscated and sent to the Deputy Principal.



Attendance

Bossley Park High School's Individual Attendance Target is 95%

Education for your child is vital. Regular attendance at school is essential for your child to achieve their educational best and increase their career and life options. NSW public schools work in partnership with parents to encourage and support regular attendance of children and young people. When your child attends school everyday, learning becomes easier and your child will build and maintain friendships with other children through social learning.

Research highlights a clear correlation between student attendance and the achievement of quality academic, socio-economic and health outcomes. This research tells us that students with an attendance rate below 90% are educationally at risk. **Above 95% is our expected student attendance.**

What is the school's expectation/standard for attendance?

Students should have less than five days' absence, per year, in order to maximise progress, success and to maintain a connection with school life.

When your child misses just one day per fortnight during their high school education, they will miss over 4 weeks of school per year and miss over one year over their school life.

What are my legal responsibilities?

Education in New South Wales is compulsory for all children between the ages of six years and below the minimum school leaving age. The *Education Act 1990* requires that parents ensure their children of compulsory school age are enrolled at, and regularly attend school, or, are registered with the Board of Studies, Teaching and Educational Standards for homeschooling.

The Importance of Arriving on Time

Arriving at school and class on time:

- Ensures students do not miss out on important learning activities in the day
- Helps students learn the importance of punctuality and routine
- Gives students time to greet their friends and socialise before class begins
- Reduces classroom disruptions

LATENESS IS RECORDED AS A PARTIAL ABSENCE AND MUST BE EXPLAINED BY PARENTS

What if my child has to be away from school?

On occasion, your child may need to be absent from school. Justified reasons for student absences may include:

- Being sick, or having an infectious disease
- Having an unavoidable medical appointment
- Being required to attend a recognised religious holiday
- Exceptional or urgent family circumstance (e.g. attending a funeral)

Following an absence from school, you will be contacted to explain this absence. You must ensure that within 7 days you provide your child's school with a verbal or written explanation for the absence. For absences longer than a two-day duration, the school requires a medical certificate to explain the absence.

Principals may decline to accept an explanation that you have provided if they do not believe the absence is in the best interest of your child.

In these circumstances your child's absence would be recorded as unjustified. When this happens the principal will discuss their decision with you and the reasons why.

Principals may request medical certificates or other documentation when frequent or long term absences are explained as being due to illness. Principals may also seek parental permission to speak with medical specialists to obtain information to collaboratively develop a health care plan to support your child. If the request is denied, the principal can record the absences as unjustified.

Travel

Families are encouraged to travel during school holidays. If travel during the school term is necessary, you must discuss this with your child's school principal. An *Application for Extended Leave* may need to be completed. Absences relating to travel will be marked as leave on the roll and therefore contribute to your child's total absences for the year.

My child won't go to school, what should I do?

You should contact the principal and school as soon as possible to discuss the issue and ask for help. Strategies to help improve attendance may include a referral to the school's learning and support team or linking your child with appropriate support networks. The principal may seek further support from the Home School Liaison Program to develop an Attendance Improvement Plan.

Working in Partnership

The Department of Education and Communities recognises that working collaboratively with students and their families is the best way to support the regular attendance of students in school.

We look forward to working in partnership with you to support your child to fulfil their life opportunities.

Further information regarding school attendance can be obtained from the following websites:

Attendance Policy & Information:

<https://policies.education.nsw.gov.au/policy-library/policies/school-attendance-policy>

The School Leaving Age:

<https://education.nsw.gov.au/public-schools/going-to-a-public-school/translated-documents/new-school-leaving-age>

Do you need an interpreter?

Interpreting services are available on request, including for the hearing impaired. The Telephone Interpreter Service is available 24 hours a day, seven days a week on 131 450. You will not be charged for this service.

For further advice and questions contact your educational services team: T 131 536

Learning and Engagement

Student Engagement & Interagency Partnerships T 9244 5129

High Potential and Gifted Education

Bossley Park High School prides itself on enriching the learning of all students, not only those who have been identified as being high potential and gifted learners. We cater for the diverse learning needs and styles of each student and offer an enrichment program for our gifted and talented classes for Years 7 – 10.

The **High Potential and Gifted Education Policy** applies to all NSW public schools, teachers, and students. It describes a framework to develop the talent of high potential and gifted students. The policy provides advice to implement effective learning and teaching practices.

The policy promotes engagement and challenge for every student in every school across intellectual, creative, social-emotional and physical domains of potential, while explicitly identifying and addressing the learning needs of high potential and gifted students.

Fundamental to the policy are issues of equity and excellence. High potential and gifted students have advanced learning capacity compared to same-age students and, as a result, require talent development opportunities and differentiated teaching and learning practices to ensure their specific learning needs are met.

High potential students are found among students of all backgrounds. Gaps in achievement, known as excellence gaps, may exist between different groups of high potential and gifted students unless specific support is provided. Such gaps further entrench inequality and disadvantage.

At Bossley Park High school, we are dedicated to meeting the needs of ALL students to ensure they meet their educational potential.

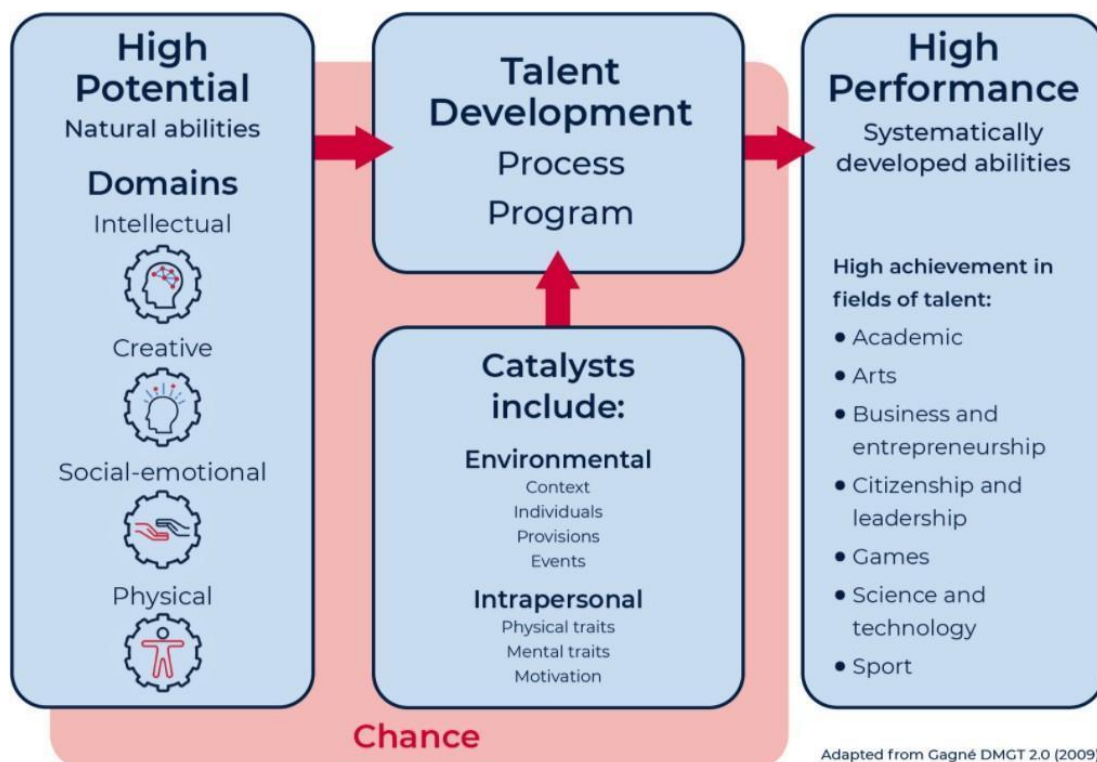

High Potential and Gifted Education

Intellectual

At Bossley Park High School we have two high performance classes in both Years 7 and 8. Students are selected to be in these classes through a combination of results from school and NAPLAN results. Students remain in this class for all core subjects including English, Mathematics, Science, Geography and History. Students that show potential in the intellectual domain may demonstrate the following learning characteristics:

- capacity for greater analytical depth
- fewer repetitions needed for mastery
- greater capability in abstract reasoning
- relative ease in making connections between disciplines
- advanced reading ability and comprehension
- knowledgeable in areas of passion
- processes information in complex ways
- enjoys hypothesising
- thrives on complexity and can see many points of view
- thinks in analogies

We offer a variety of opportunities for students to develop their potential in the intellectual domain. Some of the opportunities on offer include:

- Accelerated Mathematics
- Robotics Club
- Ethics Olympiad
- Inquisitive Minds Tournament
- Debating and Public Speaking opportunities



Physical

The Performing Arts Faculty runs courses in Music, Dance and Drama. Students have many opportunities to develop their talent in these courses. These include a variety of dance and drama ensembles, vocal group, instrumental ensemble, concert band and opportunities for weekly performances at school assemblies. These activities often lead to regional, state and national representation. Opportunities to showcase this talent include school productions, Year concerts, community activities and local competitions.



Students that show potential in the physical domain may demonstrate the following learning characteristics:

- subtlety in movement and control of body
- coordinated, balanced and confident in physical activities
- high energy levels
- superior understanding of spatial relationships
- endurance, stamina and persistence in physical activities
- suitability of body build for area of physical high potential
- demonstrates prowess in physical activities common amongst age peers
- competitive
- 'hands on' learning preference

At Bossley Park High School, we offer a variety of opportunities for students to develop their potential in the physical domain. Some of the opportunities on offer include:

- Talented Football Program (TFP)
- Talented Netball Program
- Dance Ensemble
- Industry Professional Workshops
- State Representation opportunities

High Potential and Gifted Education

Creative

Students that show potential in the creative domain may demonstrate the following learning characteristics:

- educational risk-taking
- tolerance for ambiguity
- makes unusual associations between different ideas
- demonstrates creative thinking across domain areas and in the different disciplines
- demonstrates novel thinking in written and oral expression
- flexibility and divergence in thinking
- unusual ability for expressing self through art, dance, drama, music
- creates several solutions to a given problem
- synthesises a variety of ideas in original ways



At Bossley Park High School, we offer a variety of opportunities for students to develop their potential in the creative domain. Some of the opportunities on offer include:

- Game Changers Challenge
- Visual Arts -Art Hub, Visiting Artists and skill development workshops
- Extracurricular Workshops for Creative and Performing Arts
- Project Based Learning (PBL) Teaching and Learning Programs
- Write a Book in a Day Workshop



Social-emotional

This program is designed to offer opportunities to students with a talent in Visual Arts. These opportunities include: students participating in extra-curricular workshops to extend and challenge their abilities, working with visiting artists to learn new skills and techniques and attend excursions and art galleries where students can appreciate art in different contexts.

Students that show potential in the social-emotional domain may demonstrate the following learning characteristics:

- advanced organisational and management skills
- advanced social and communication skills
- emotional stability
- empathy
- demonstrated leadership and decision-making skills
- resilient and self-aware
- foresees consequences and implications of decisions
- respected by peers
- self-confident
- task analysis and backwards mapping abilities
- social justice advocacy



At Bossley Park High School, we offer a variety of opportunities for students to develop their potential in the social-emotional domain. Some of the opportunities on offer include:

- Student Representative Council (SRC)
- Interact Club
- Entrepreneur Program
- Refugee Leaders Program
- Positive Behaviours for Learning (PBL) Committee



Talented Football Program

The [Talented Football Program](#) is the longest standing gifted and talented program at Bossley Park High School beginning in the early 1990's. The program has changed over the years, to the point where football is offered as a subject during sport and PDHPE elective classes with students learning in a practical and theory setting. The program provides a holistic approach to education for student athletes and is designed to provide additional training opportunities to support young players motivated to reach their potential, while at the same time pursuing a first class education. The program aims to help provide more opportunities to players, develop additional player pathways and support the long-term development of young players.

The Gifted and Talented Football Program is dedicated to providing a learning environment to maximise the football education of junior and youth players in order to assist them in attaining their goals of reaching an elite level within a variety of football career paths. The course is designed to educate and challenge student athletes in all aspects involved within the world of football. A specific focus is on the technical and tactical components of the game with sessions designed to create a competitive, as opposed to competition environment. Other areas covered include refereeing, coaching, media, sports, science and event management. Bossley Park High School has employed an international football coach to support the Talented Football Program.

The talented football program at Bossley Park High School has a rich and proud tradition of developing players that have represented their country and have gained professional playing contracts in Australia and abroad. The talented football staff work tirelessly to develop our current and future students, in achieving their dreams of playing professional football. Any enquiries can be directed to the head teacher of TFP, Mr Scott Belgre.

The program includes:

- Boys and girls program, inclusive in each year group
- Weekly practical training sessions embedded into the timetable and curriculum
- Injury prevention program
- Referee accreditation
- Coaching accreditation
- Performance analysis
- Event Management training

TFP program expectation:

Year 7 The Talented Football Program is run in the allocated Sport period on the student's timetable. Identified students will take part in the Football competitions organised. Students may be expected to train before or after school as decided throughout the year.

Year 8–10 Students are encouraged to study the PASS elective that is designed for the TFP student.

Year 11 and 12 Students have the opportunity to elect the senior course SLR to continue their studies in TFP. Please note: Students may be expected to train before or after school as decided throughout the year.

Coaching Staff

Devrim Gaziler- Head Teacher TFP and PDHPE
 Joe Haywood- TFP Head Coach
 Geoff Stanmore- TFP Coach
 Elvis DeMarchi- TFP Goalkeeper Coach
 Roberto Speranza- TFP Physio
 Alex Pucciarelli- TFP Physio



Robotics Club

The Bossley Park High School Robotics club has coined the phrase “Learning through Opportunity & Opportunity through Learning”. The clubs’ activities, ethos and ecosystem allow students to engage professionally, graciously and respectfully with peers, mentors, business, industry, universities, community, building skills of the future through robotics, technology, electronics, and programming. The students are empowered and given opportunities to engage in outreach programs to assist their local community, their school, local schools, and even internationally, spreading their love of Robotics and STEM.

Each year our students engage in multiple National and International tournaments and events, giving our diverse students the opportunity to compete graciously and professionally.

Most of the tournaments engage students to meet challenges well beyond their capabilities, testing their STEM technical skills and knowledge, problems solving, creativity, team skills, communication and personal value systems. Students are taken out of their comfort zone and are given the opportunity to learn to engage with other students and mentors from other schools around Australia and Internationally.

The club has fostered many opportunities for graduating year 12 students, to showcase their passion and skills and have been granted pre-HSC University entry and scholarship programs in tertiary education at Macquarie University and UNSW because of their consistent engagement with the program. Students from the club have also developed entrepreneurial skills and student led businesses are beginning to grow, providing services and goods to communities and industry.

Much of the work developed within the Robotics Club has found its way into our curriculum through the Technology mandatory course in Stage 4, iSTEM (integrated STEM), IST and Industrial Technology Engineering course in Stage 5, Software Design and Development and Engineering Studies in Stage 6.

The efforts of the club have found their way to our local newspapers and to the Department of Education conferences on STEM education and future learning.

We can’t help but acknowledge and show our appreciation to Bossley Park High School, FIRST Australia, Google, Ford, Lego Education, AARNET, Sydney University, and many more that have helped and supported the work.

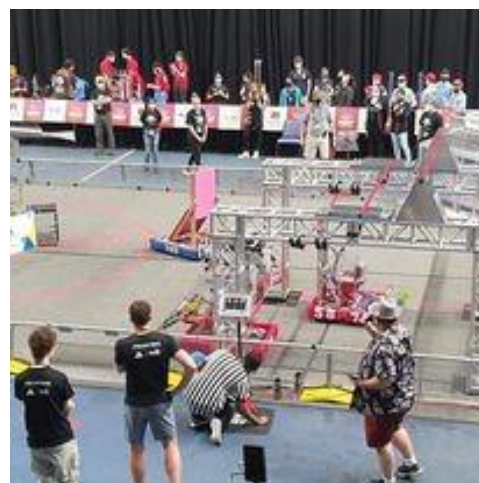



Bring Your Own Device

Why BYOD?

BYOD (Bring Your Own Device) refers to students being allowed to bring a personally-owned device to school to complement their learning in the classroom. In this digital age students need to be highly skilled and productive users of technology to prepare them for a rapidly changing workforce. Students will learn to solve problems collaboratively and creatively, and learn to use technology safely and ethically.



Which device?

Students may bring a laptop or notebook computer to school. The device should meet the specifications recommended by the school below. The device can be purchased from any computer retailer, Harvey Norman, JBHIFI, Bing Lee etc.



Device specifications:

- **Wireless connectivity**

Devices must support the **802.11n 5GHz** wireless dual band wireless standard. Devices that do not meet this standard will not be able to connect to our network.

- **Operating system**

Devices should have the current or a recent version of the relevant operating system installed, such as Windows 10, Windows 11 or MacOS 13.0.

- **Battery life**

Devices must have at least 7 hours of battery life without charging. Devices must be fully charged before school each day. Students are not permitted to charge devices at school. It is the students responsibility to ensure their device is fully charged each day.

- **Hardware, storage and RAM**

Devices should have a screen size of 11 inches, an appropriate keyboard, USB connectivity and inbuilt webcam and microphone. They should have 256GB storage and 8GB RAM.

- **Software and apps:**

Devices should have a web browser installed. Students are offered free Microsoft Office 365 and Adobe Creative Cloud.

- **Getting involved:**

To begin using your device at school, students and parents must sign the BYOD user charter and return it to the TSO's office. Students must keep their devices safe and secure at all times, and ensure that use of devices is in accordance with Bossley Park High School and Department of Education policies. Families may choose to purchase insurance for their devices.

Core Rules

Core rules for students in NSW government schools

Students in NSW government schools are provided with a high quality education so that they may learn to the best of their ability and become self-disciplined, tolerant, enterprising and contributing members of the school and community.

Core rules for student behaviour have been developed to establish consistent expectations in all government schools in support of these aims.

These rules are based on our core values of integrity, excellence, respect, responsibility, cooperation, participation, care, fairness and democracy.

The critical role of parents and caregivers is recognised as the primary influence on each child's character and behaviour and as essential partners in supporting the core rules and the successful education of their children.

The Department is committed to supporting principals and school staff in the implementation of these rules through state wide policies and programs, together with regional support staff, professional learning and alternative provisions, in order to promote the highest standards of behaviour and learning in our schools.

The core rules

All students in NSW are expected to:

- Attend every school day, unless they are legally excused, and be in class on time and prepared to learn.
- Maintain a neat appearance, including adhering to the requirements of the school's uniform and dress code policy.
- Behave safely, considerately and responsibly, including when travelling to and from school.
- Show respect at all times for teachers, other school staff and helpers, including following class rules, speaking courteously and cooperating with instructions and learning activities.
- Treat one another with dignity and respect.
- Care for property belonging to themselves, the school and others.



Behaviour that infringes on the safety of others, such as harassment, bullying and illegal or anti-social behaviour of any kind, will not be tolerated.

Core Values

The Government recognises the importance of the following core values to the community. These values represent the aspirations and beliefs of the Australian community as a whole, including its concern for equity, excellence and the promotion of a caring, civil and just society.

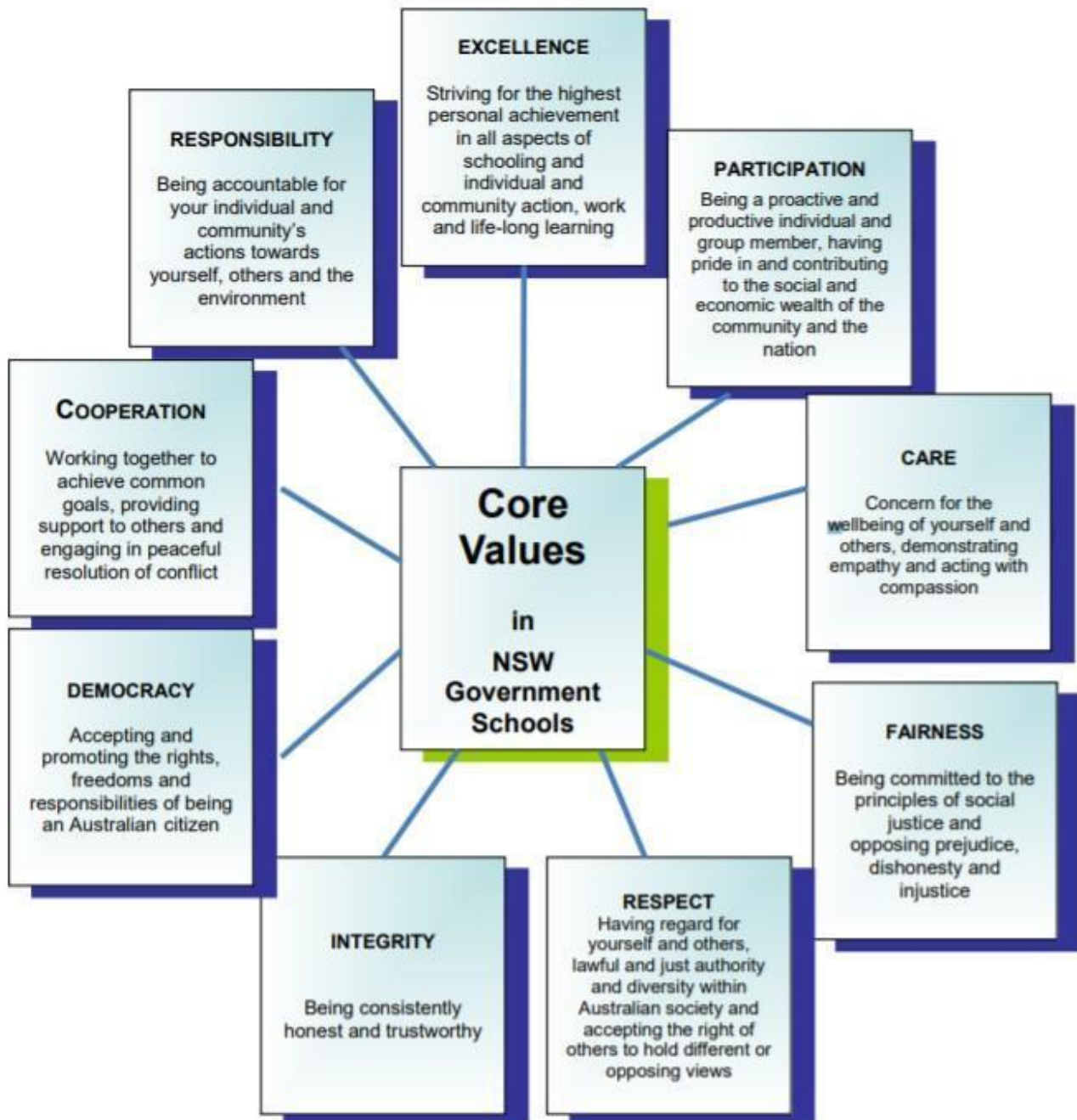

Core values in NSW Government Schools

School Safety

Schools and their communities work together to provide quality learning environments which are:



All students and staff have the right to be treated fairly and with dignity in an environment free from disruption, intimidation, harassment, victimisation and discrimination. To achieve this, all schools are expected to maintain high standards of discipline. **(Related policy – Suspension and Expulsion of School Students Procedures).**

There will be cases of unacceptable behaviour where it will be in the best interests of the school community and/or student involved, for the student to be removed from the school for a period of time or completely. This may apply in the following circumstances:

Continued disobedience – This includes, but it is not limited to, breaches of the school discipline code such as refusal to obey staff instructions; defiance; disrupting other students; minor criminal behaviour related to school; use of alcohol or persistent use of tobacco. ***Alcohol must not be consumed or brought onto school premises and smoking on the premises is prohibited.***

Aggressive behaviour – This includes, but is not limited to hostile behaviour directed towards students, members of staff or other persons, including verbal abuse and abuse transmitted electronically such as by email or SMS text messages; using an electronic device to film criminal behaviour, sharing the film with others or posting it on the internet.

Physical Violence which results in pain or injury or which seriously interferes with the safety and wellbeing of other students and staff.

Use or possession of a prohibited weapon, firearm or knife.

Possession or use of suspected illegal substance or restricted substances such as prescription drugs. Schools must be a place free of illegal drugs.

Use of an implement as a weapon or threatening to use a weapon.

Serious criminal behaviour related to the school – This includes being present or as part of a group while a crime is being committed.

Persistent misbehaviour – This includes, repeated refusal to follow the school discipline code; making serious threats against staff or students; behaviour that deliberately and persistently interferes with the rights of other students to learn or teachers to teach.



Bossley Park High School

Mobile Phones at School

To ensure the safety of students is prioritised and that educational outcomes for students are maximized, through the appropriate use of technology, mobile phones are not permitted at school. This procedure has been developed by Bossley Park High School in consultation with the Community Support Group (CSG).

Mobile phones and earphones/airpods must not be used on school premises for any purpose. (this includes the classroom and playground)

Every student at BPHS will be assigned a personal Yondr Pouch. While the Yondr Pouch is considered school property, it is each student's responsibility to bring their Pouch with them to school every day and keep it in good working condition.

DAILY PROCESS

As students **Arrive to School**, they will:

1. Turn their phone off.
2. Place their phone inside their Pouch and secure it **before entering school grounds**.
3. Store their Pouch in their backpack for the day.

At the end of the day, students will open their Pouch using unlocking stations located near school exits, remove their phone, and put their Pouch in their backpack. Students must bring their Pouch to school with them each day. *Students arriving late or leaving early will pouch/unpouch their phones in the front office under the supervision of office staff.

Pouch Damage / Lost Pouch / Using Phone During School

If a student damages their Pouch they will be expected to pay a replacement fee of \$20 to replace the Pouch.

Examples of damage:

- Deep scratches on the globe and on the green ring around it
- Bent pins
- Pin and button not fully recessing, due to pin damage



Forgotten Pouch

If a student forgets their Pouch, **their phone will be confiscated and school staff will call home to remind the Parent of the policy.** The phone will be returned to the student at dismissal.

If parents need to make contact with their child during school time they can ring the school's front office 9823 1033. If students need to ring home they are to seek assistance by speaking with the senior executive or front office.

This procedure applies to all students at BPHS.

Mobile phone usage in classrooms generates substantial barriers to student engagement and student learning. Their use within the playground has also generated issues affecting the safety of students such as bullying and the distribution of inappropriate content, including video.

Students who fail to comply with the school's procedure within school grounds will be sent to the Deputy Principal to hand in their mobile phones or earphones/airpods. The Deputy Principal will keep the phone in a secure location and record the student's name and the date. The mobile phone or earphones/airpods will be returned to the student at the end of the school day. Persistent inappropriate use of mobile phones will be managed through the school's welfare and discipline policy.

Merit System

Positive Rewards to Recognise and Reinforce Student Behaviour

It is essential that students receive recognition for good behaviour, responsibility, effort and achievement. Teachers reinforce positive behaviour by utilising the school systems, in combination with their own or faculty recognition schemes. This aspect has been enhanced by the Positive Behaviours for Learning program (PBL) which shifts the focus from discouraging inappropriate behaviour to encouraging appropriate behaviour, so that students will become safe, respectful learners.

Students receive Merit Awards and PBL points for recognition of any of the following:

High Achievement <ul style="list-style-type: none">• Improvement, consistency, excellence, sustained good effort, cooperation, participation, quiet achiever, etc.	Outstanding Engagement <ul style="list-style-type: none">• Most improved, or personal growth in their learning	Sport <ul style="list-style-type: none">• Improvement, consistency, excellence, sustained good effort, cooperation and participation, quiet achiever, good sportsmanship, etc.
School Representation <ul style="list-style-type: none">• Sport, debating, public speaking, interschool competitions, forums, displays, etc.	School and Community Service <ul style="list-style-type: none">• Returning valuable lost property, charity work, helping at school functions / volunteering for school programs, assembly participation, work experience, etc.	Safe, Respectful, Learner <ul style="list-style-type: none">• I will complete all my work to the best of my ability.• I will follow the teacher's instructions.• I will bring correct equipment to every lesson.• We will listen to each other.• We will speak to each other in a positive manner.

Merit System

Junior students – Achieving Plus 2:

1. Collect 5 white merit awards from DIFFERENT SUBJECT AREAS for academic performance, attitude/effort, sport, service or school representation
2. Get a MAC card and fill it out with the details of your merit awards
3. Put your completed MAC card and merits in the box outside the Head Teacher Student Wellbeing's office
4. Receive your award at assembly and you are eligible for the Plus 2 excursion.

Junior students – Achieving Plus 3:

1. Reach Plus 2 level
2. Collect another 10 white merit awards from ANY SUBJECT AREA and complete your MAC Card.
3. Put your completed MAC cards and merits in the box outside the Head Teacher Student Wellbeing's office
4. Receive your award at Presentation Evening and you are eligible for the "Student of the Year" Award.

Senior students – Achieving Plus 2:

1. Collect 4 white merit awards from DIFFERENT SUBJECT AREAS for academic performance, attitude/effort, sport, service or school representation
2. Get a MAC card and fill it out with the details of your merit awards
3. Put your completed MAC card and merits in the box outside the Head Teacher Student Welfare's office
4. Receive your award at assembly and you are eligible for the Plus 2 excursion.

Senior students – Achieving Plus 3:

1. Reach Plus 2 level
2. Collect another 8 white merit awards from ANY SUBJECT AREA and complete your MAC Card.
3. Put your completed MAC card and merits in the box outside the Head Teacher Student Welfare's office
4. Receive your award at Presentation Evening and you are eligible for the "Student of the Year" Award.

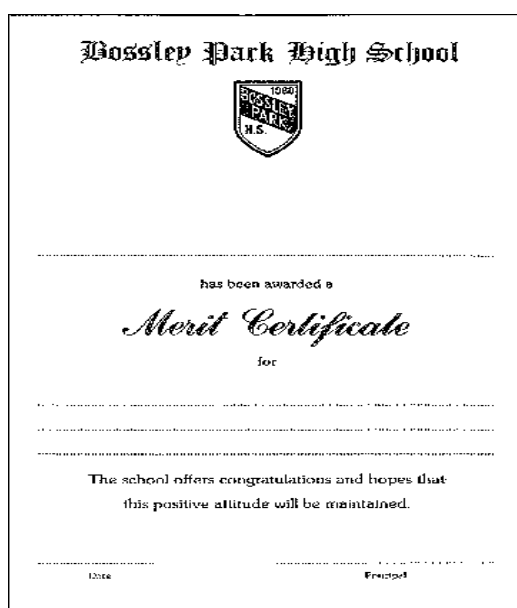

PBL Reward System

PBL Reward system *for*

Safe
Respectful
Learners



PBL Team

*Promoting Positive Behaviours in
Learning*

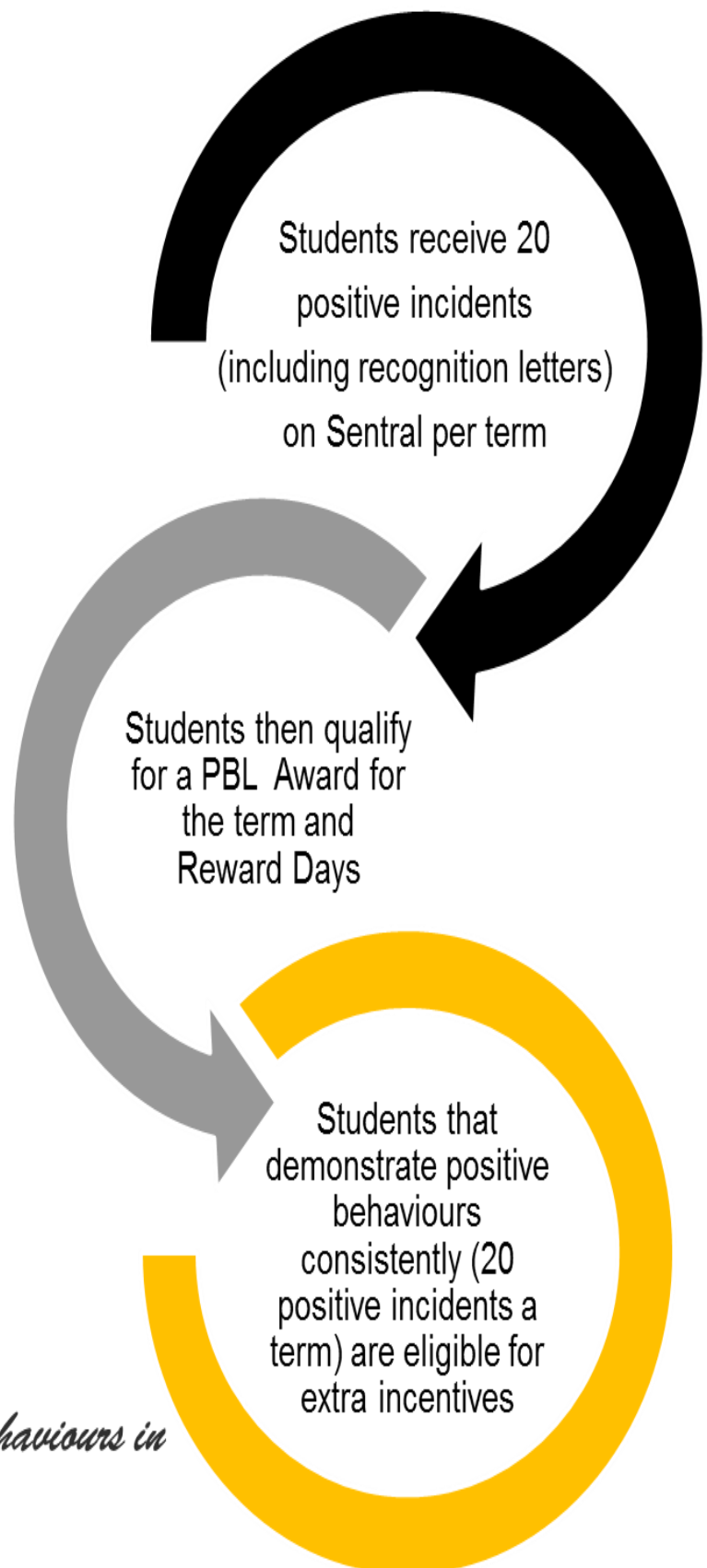

School Library

The Bossley Park High School Library is a well-stocked and resourced facility that can be utilised in many ways.



Mrs F. Weir Head Teacher Librarian

Borrowing:

Students need to have a current Library /ID card to borrow books and equipment, they will be issued with one at the start of their schooling or can purchase a replacement card for \$5 at any time from the library staff. Students will not be permitted to enter the library without their library card.

The library stocks a large range of sports equipment such as footballs which are available to borrow for lunchtime games. Simply ask at the front counter.

Technology- staff may give permission for students to borrow laptops from the Library during class time, but must be returned at the end of each lesson, as they can be booked in advanced by other classes.

Desktop computers are also available within the Library and may also be booked in advanced by staff for a class lesson, however if they are free, individual students may have access to them.



Printing:

Students may make use of the library photocopier for a small fee. It does print in black and white or full colour sizes A4 and A3. All students are provided with a one off \$5 printing credit on enrolment. However students are encouraged not to leave printing of assessments to the last minute, as the library may need to be closed due to exams or special events on rare occasions.

Study Periods:

Senior students who attend TAFE or other training courses may have study periods on their timetable, during these times they should get their name marked off and remain to be supervised in the library. They will have access to all of the library's facilities for their private study.

Agriculture

In Year 7 Agriculture is a component of the Technology (Mandatory) course. All students study Agriculture for 13 weeks. Agricultural Technology is an elective course that can be studied in Years 8, 9 & 10. Agriculture can also be studied in Years 11 & 12 for the Higher School Certificate.



Our honey has won many awards at the Royal Easter Show. Thank you to our Farm Assistant Nick O'Neill and Agriculture Teacher Elena Dagher (pictured).



Bossley Park High School has a farm, which is used by students studying Agriculture. Throughout the year, we keep a variety of animals at the farm including layer hens, meat chickens, ducks, goats, sheep, pigs, guinea pigs, bees and dairy calves. We also grow many different crops including citrus fruit, vegetables and herbs. Students who study Agriculture will take part in the raising of these crops and animals.

Students may choose to join our Agriculture Show Team and exhibit some of our animals at the Royal Easter Show and other local shows.



Disability Support Unit

Faculty Vision

Our vision is to give students with disabilities the best educational opportunities, experiences and skills to help them succeed in life.

Our Aims

To create safe and supportive learning environments where students are encouraged to take risks in their learning, to explore, grow and develop in their journey towards greater independence and self-advocacy. To deliver innovative and meaningful learning experiences to establish a culture of inclusion and participation in the wider-school community including programs with their non-disabled peers. To develop and foster positive partnerships with parents and caregivers to ensure every student is known and valued as well as empowering students with disabilities to take control of their own lives.

Accessibility

Accessibility features currently available for students with physical disabilities at Bossley Park High School include:

- A wheelchair accessible school bus for use on excursions and community access
- Accessible toilet and shower facilities including handrails, ceiling and portable hoists
- Wheelchair accessible classrooms with height adjustable tables
- DSU COLA (covered outdoor learning area)
- Stage lift for wheelchair access in school's multi-purpose centre
- Outdoor exercise

Technology:

Adaptive technologies currently available for students with physical disabilities at Bossley Park High School include:

- adaptive equipment such as pencil grips, slope boards, height adjustable desks, foot supports, book holders and cooking utensils
- a dedicated wheelchair accessible computer laboratory with adapted access and hardware features
- interactive whiteboards in all classrooms



Careers

Career Advisor

At Bossley Park High School, we are committed to working with you and your child to achieve success in their own area and/or assist all students explore their interests to create a pathway that will transition them from school to work smoothly.

The Careers department is able to:

- Conduct personal interviews with each student from years 10, 11, and 12
- Assist students to create and implement a study timetable to benefit them
- Explore various career pathways and post-school options
- Offer special programs that will benefit the student before they finish school, for example, work experience.
- Hold group transition meetings to expose different methods of achieving a long-term goal after school life has finished.
- Show students various methods of managing stress, anger and teach them how they can work with their unique way of learning.
- Help students identify their learning styles and how to overcome barriers to achieve success inside and outside of the classroom.



Ms A Chehade

Head Teacher Secondary Studies + Senior Transition Adviser

A Transition Adviser is a member of the school's career and transition team, to develop good connections with students in order to provide program tuition, mentoring and advocacy, which support young people in transition. Creating and strengthening new and existing partnerships between the school, industry and outside agencies. The Transition Adviser promotes effective communication strategies between school, employers and local community by seeking local solutions through specialised community support for those students most likely to disengage from school early through developing programs offered within the school and externally. They provide links with Local Community Partnerships, additional educational pathway providers, and other local community initiatives to seek additional opportunities for students.

The Transition Adviser is a true and consistent source of support by assisting the student "over the humps" through offering a range of opportunities and presenting possibilities. They work alongside that young person, and their significant adults (teachers, parents, carers, employers, youth workers) to translate the young person's transition/ retention plan into action.

Ms K O'Connor



Curriculum

Year 7

Subject	Periods each fortnight
English	4
Mathematics	4
Science	4
History	4
PD/H/PE	3
Technology	4
Music	4
Visual Arts	4
Languages (Spanish)	4
Sport	2
Literacy	2



Year 8 Electives

Human Society and its Environment

- Commerce
- History

Science

- Agriculture

Languages other than English

- Spanish
- Italian

Personal Development / Health / Physical Education

- Talented Football

Technological and Applied Studies

- 3D Design
- Computer Aided Engineering
- Food Technology
- iSTEM (Robotics and Coding)
- Industrial Technology - Timber
- Information Software Technology

Creative and Performing Arts

- Dance
- Drama
- Music

Visual Arts

- Visual Arts
- Design

Year 8

Subject	Periods each fortnight
English	5
Mathematics	6
Science	6
Geography	4
PD/H/PE	4
Technology	4
Sport	2
Literacy	2
Electives x2	6

Curriculum

Year 9

Subject	Periods each fortnight
English	5
Mathematics	6
Science	5
Geography	4
History	4
PD/H/PE	4
Sport	2
Electives	8
Literacy	1

Year 10

Subject	Periods each fortnight
English	6
Mathematics	6
Science	6
HSIE	4
PD/H/PE	4
Sport	2
Electives	10
Careers	1

Year 9 & 10 Electives

Mathematics <ul style="list-style-type: none"> Accelerated Mathematics (Invitation Only)
Human Society and its Environment <ul style="list-style-type: none"> Commerce Philosophy History Elective
Languages other than English <ul style="list-style-type: none"> Spanish
PDHPE <ul style="list-style-type: none"> Physical Activity and Sports Studies Talented Football (Invitation Only)

Technological and Applied Studies <ul style="list-style-type: none"> Food Technology Industrial Technology - Timber Industrial Technology - Engineering Industrial Technology - Graphics iSTEM Textiles Technology
Creative and Performing Arts <ul style="list-style-type: none"> Dance Drama Music
Visual Arts <ul style="list-style-type: none"> Visual Arts Visual Design Photography

Charges & Administration Costs Year 7, 8, 9, 10

Year 7

Description	Charge
Administration Charge	\$50.00
CSG Levy	\$2.00
E-Learning	\$33.00
Sport Charge + Swim School	\$90.00
MANDATORY TOTAL	\$175.00
Talented Football Program	\$1,000.00

Year 8

Description	Charge
Administration Charge	\$50.00
CSG Levy	\$2.00
E-Learning	\$33.00
Sport Charge	\$30.00
Elective Courses x2	\$30.00
MANDATORY TOTAL	\$145.00
Talented Football Program	\$1,000.00
TFP students will be required to pay for 1 elective course charge	\$15.00

Year 9

Description	Charge
Administration Charge	\$50.00
CSG Levy	\$2.00
E-Learning	\$33.00
Sport Charge	\$10.00
Elective Courses x2	\$50.00
MANDATORY TOTAL	\$145.00
Talented Football Program	\$1,000.00
TFP students will be required to pay for 1 elective course charge	\$25.00

Year 10

Description	Charge
Administration Charge	\$50.00
CSG Levy	\$2.00
E-Learning	\$33.00
Sport Charge	\$30.00
Elective Courses x2	\$50.00
MANDATORY TOTAL	\$145.00
Talented Football Program	\$1,000.00
TFP students will be required to pay for 1 elective course charge	\$25.00

Charges & Administration Costs Year 11 & 12

Year 11

Description	Charge
Administration Charge	\$50.00
CSG Levy	\$2.00
E-Learning	\$33.00
Senior Textbook Hire	\$50.00
Sports Carnival	\$10.00
Courses x5	\$100.00
MANDATORY TOTAL	\$245.00
Additional Charges	Charges
Hospitality Uniform (<i>ordered directly from supplier</i>)	\$75.00
Talented Football Program	\$1,000.00
TFP students will be required to pay for 4 elective course charge	\$80.00

Year 12

Description	Charge
Administration Charge	\$50.00
CSG Levy	\$2.00
E-Learning	\$33.00
Sports Carnival	\$10.00
Courses x5	\$100.00
MANDATORY TOTAL	\$195.00
Additional Charges	Charges
Senior Textbook Hire (<i>if commencing at BPHS in Yr12</i>)	\$50.00
Talented Football Program	\$1,000.00
TFP students will be required to pay for 4 elective course charge	\$80.00





Statements of Account – Online Payments

Bossley Park High School will be sending student statements of account directly to parents via email using a system called School Bytes. These statements will include a link to make secure payment online through the Westpac Parent Online Payment (POP) system (Visa/Mastercard credit & debit cards accepted).

To make an online payment for your child(ren)'s school fees, please follow the steps below:

1. You will receive an email from the school's email address(bossleypk-h.school@det.nsw.edu.au) with the subject 'Student Statement of Account'. All children in a family will be included in the same email.

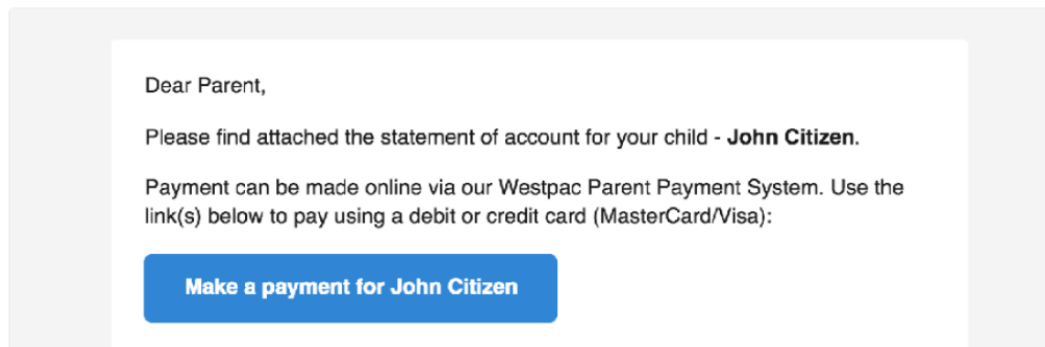

2. To make an online credit card payment, click the secure payment button in the email.

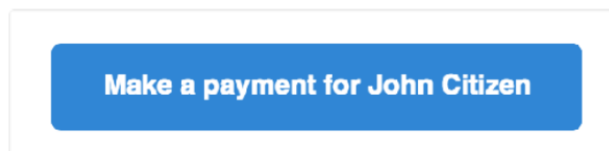

3. Once this button is clicked, you will be taken to the following page. On this page, you will see a list of all currently outstanding school fees for your child. By default, all fees are selected/ticked for payments.

Parent Online Payment Portal

Sample High School

Student Details

Name: CITIZEN, John
Number: 4444444444

Family Details

Opening Balance: \$0.00
Unallocated Credit: \$0.00

School Details

Downloads
Invoice Letter
Online Payment Instructions

Grand Total: \$463.00

Statement of Account for John Citizen
Current as of: 18/09/2017 04:31pm

Listed in the table below are the items currently owing on the statement of account for your child. Use the checkboxes to select what items you wish to pay at this time.

Once completed, fill out the 'Payer Details' and press 'Next' at the bottom of the page.

N.B. Payments made online can take up to 48 hours to be processed by the school and reflected on this payment page.

<input checked="" type="checkbox"/>	Date	Due	Fee Name	Amount	Paid	Balance Owing (\$)
<input checked="" type="checkbox"/>	05/04/2017		Gymnastics for Gymnastics	\$40.00	\$0.00	40.00
<input checked="" type="checkbox"/>	05/04/2017		Japanese Drum for Japanese Drumming	\$5.00	\$0.00	5.00
<input checked="" type="checkbox"/>	05/04/2017		LiteratLevy for Yr 6 Literature Levy Not OC	\$18.75	\$0.00	18.75
<input checked="" type="checkbox"/>	05/04/2017		Paper for Paper Levy 2017	\$18.75	\$0.00	18.75
<input checked="" type="checkbox"/>	05/04/2017		Science-Levy for Science Levy	\$5.00	\$0.00	5.00

4. If you wish to change the amount you would like to pay for an item, enter the desired amount in the text field under the column 'Balance Owing'.

To not pay for a certain item, untick the checkbox in the left-hand column of the table next to the fee you wish to remove.

<input checked="" type="checkbox"/>	27/01/2017	Yr10 Technology Support	\$30.00	\$0.00	30.00
<input checked="" type="checkbox"/>	01/02/2017	Yr10 Maths - online programs	\$24.00	\$0.00	24.00

5. Once you have selected what fees you wish to pay, enter your name, phone number and email address under 'Payer Details'. This allows the school to know which parent/caregiver is making the payment.
- Now, press the 'Next' button to be redirected to a secure Westpac site to finalise your online payment.

☒ 16/05/2017

Mathematics Competition 27/7/17

\$6.00

\$0.00

6.00

[\\$ Add Tax Deductible Item](#)

[+ Add Other Fee](#)

Grand Total: \$1028.00

 Payer Details

Your Name:

Contact Phone Number:

Contact Email:

You will be redirected to a secure Westpac site to make your online payment.

[Next >](#)

6. Once redirected to Westpac, you will see the following screen. Enter your credit card details into the appropriate text fields on this screen. Once ready, press 'Next'.

IF YOU REALISE YOU HAVE MADE A MISTAKE IN SELECTING WHAT ITEMS YOU WISH TO PAY ON THE

Payment Details

Fields marked with an asterisk (★) are mandatory.

You are paying to:

Payment Amount:

\$100.00 AUD

★ Card Holder Name:

★ Credit Card Number:



★ Card Expiry Month:

★ Card Expiry Year:

★ Card Verification Number (CVN): [What's this?](#)

Click **Next** to proceed to the confirmation page where you can review your payment details.

Cancel

Back

Next

PREVIOUS PAYMENT PORTAL SCREEN, PLEASE CLICK THE LINK IN THE ORIGINAL EMAIL AND START AGAIN.

7. You will then see a payment summary screen where you confirm your details. When ready, press the button at the bottom of the page to confirm and make your online payment.

NOTE: To pay for another child in the family, return to the original email you received and click the payment button with the other child's name on it.

School Map

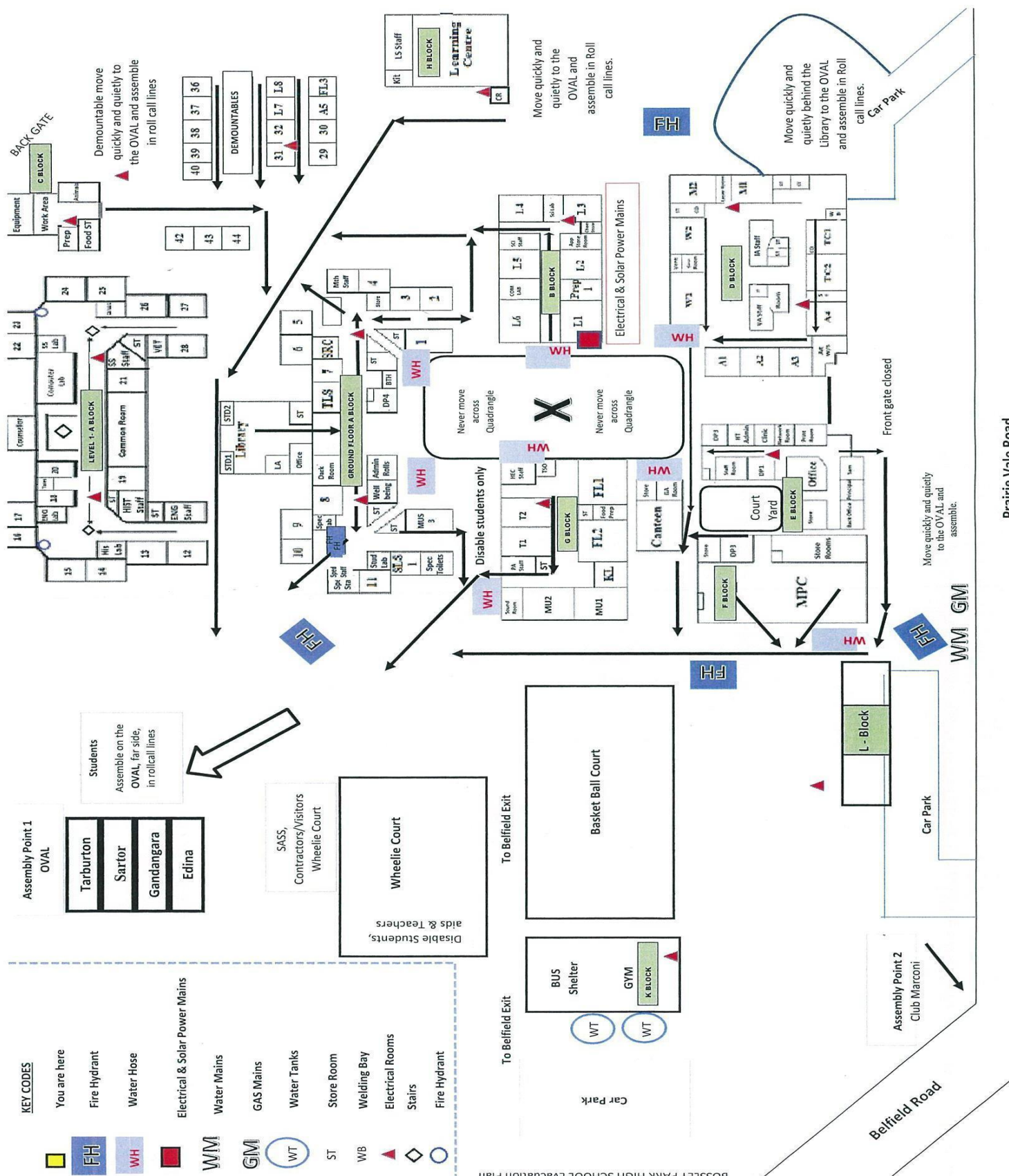

Parent and Carer Information

Bossley Park High School welcomes Community Participation in the school. The community includes students, teaching staff, the executive, support staff, parents, interested community members, local industry and teachers of support programs. The school community is invited to participate through numerous meetings and school events, such as outlined below:

Community Support Group (CSG)

This group encourages all parents to be involved and informed in the decision making of the school. The CSG meets monthly on the third Tuesday of each month at 6.30pm in the Learning Centre, during the school term. Curriculum issues are discussed at most meetings. Every student in their school charges, is invoiced a \$2 CSG levy which goes towards fundraising.

The first meeting will be on Tuesday 21st February 2023. All parents are welcome to attend.

School Website

<https://bossleypk-h.schools.nsw.gov.au/>

School Newsletter 'Bossley Biz'

A school newsletter is issued electronically via email and social media or accessible from the school's website. Current and past newsletters are readily available on the school's website. Our school newsletter and website provide valuable information for both parents and students.

Social Media

<https://www.facebook.com/BPHSWellbeing>

School Bytes

Bossley Park High School uses School Bytes for financial payments including fees/levies and excursions. Parents will receive family statements with a link to Parent Online Payments via email. Excursion notes may also be emailed to you with links to payment. School Bytes allows for installments or full payments to be made. If you do not have an email then you will receive your statement in the mail.

Reports – Parent/Teacher Interviews

The school issues two reports to parents/guardians each year. School reports are issued twice a year at half yearly intervals. Parents make appointments to see their child's teachers with an online booking service on the Sentral Parent Portal System. Login details are provided to parents closer to Parent/Teacher evening dates.

Frequently Asked Questions

What do I do when I arrive at school?

Move to and remain in the playground. You are not to remain near the entrance gate, leave the school or use the school oval before school.

What do I do if I'm sick?

Your parent/guardian will need to respond to the SMS sent to his/her mobile or bring in a note from parent/guardian the next day. If you are absent from school for 2 or more consecutive days a Doctors Certificate is required.

What do I do if I'm late?

All students who arrive late (after the period one start bell) **MUST** report to the school administration front office to collect a late arrival slip. These students will be marked as a **PARTIAL** absence for the day. All students must provide a signed note by a parent with a valid reason, "Slept in and traffic" will not be accepted. Students must show the late arrival slip to their period one class teacher on the day. (*This is to avoid any discrepancies*). Students with high rates of lateness to school will have consequences. These students may be required to report to the Principal, Deputy or HT Administration to be given a clean-up duty, lunch detention or senior students may be required to stay back on Thursday period 4 also.

What do I do if I need to leave early?

Application for an early leavers pass can only be made prior to period 1 each day. A letter from your parent/carer stating the following must be supplied – Your name, year, roll call, date, time, reason and a mobile contact number to verify requests. Parents/carers are reminded that all students are to be signed out and picked up via the school administration office. If your year 12 child is required to catch the bus, walk or drive themselves to their destination, it must be clearly stated on the permission note. (**Notes can be found in the purple Student Absentee Booklet**). This letter must be placed in the box outside the Head Teachers Administration Office labelled Attendance Box, prior to period 1 each day. Early Leaver passes can be picked up at recess from the Head Teachers Administration Office door. Students are to exit the school via the School Administration Office presenting the pass to be verified.

What do I do if I am absent from school?

Students must bring a note in on the very next day. If you are absent for 2 or more consecutive days a Doctors Certificate is required. The note must have the date/s, reason and a parent/carer signature. Parents are advised to use the **Purple Student Absentee Booklet** provided by the school. They contain a section for your own records and the note that your child gives to their roll call teacher upon return from an absence. The booklet can also be used for a student's early leaver pass or lateness to school pass. **All parents are notified of their child's absences (whole and partial) each day via SMS.** *If your email address or mobile contact for SMS is not recorded with the school, please contact the school administration office on 9823 1033 and provide your current details.* Attendance rates are monitored regularly

– Bossley Park High School is known for its high expectations towards attendance. Students with poor attendance rates- ie below 90% will be interviewed by Head Teacher Administration, Year Advisors and the Home School Liaison Officer (HSLO). These students will be put on an attendance card and improvements must be made. Failure to improve will result in an attendance plan monitored by the HSLO. Students who fail to bring in a note explaining their absences will be reminded by their roll call teacher. Lunchtime detentions may be issued for repeat offenders. If a student is absent for **three or more consecutive days** parental contact will be made by Head Teacher Administration.

What do I do if my family is planning a holiday?

Bring in a note from your parent/guardian to explain the circumstances, eg: where you are going, the dates of your leave and the reason for your trip, to the school administration office. This note needs to be handed into the school administration office; you may be called upon to provide further information. On return to school, check with your teachers what work you have missed and catch up on this work.

Extended leave must be approved by the principal.

What do I do if I have a uniform issue?

Bring a note in from your parent/guardian explaining the reason for not wearing the correct uniform items and give it to your deputy principal before school. Your deputy principal will issue you with a uniform pass.

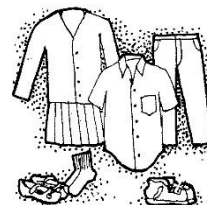

What do I do if I am sick or injured at school?

You need to notify your nearest teacher. You do **not** contact your parents by phone.

The teacher will issue you with an 'out of class pass' and you are to report to the Deputy. You will then report to the school administration office where first aid can be administered or parents can be contacted to collect you from school.



What if I need to take medication at school?

All students who need to take medication while at school should leave the medication with the school administration office. A letter needs to accompany the medication explaining the reason for the medication and the dosage required and times.

If you are late between classes

You must have a note from your previous teacher explaining the reason why you are late to the next class.

If your parents need to drop something off for you at the school

All visitors are to report to the school administration office.

Parents/guardians/friends are not to go into the school grounds and approach students. Items brought to the school administration office for students must be clearly labelled with the student's name. If you know your parents are dropping off something for you, please collect from the school administration office during your break times.



If you are leaving/transferring school

You must bring in a note from your parents to the Principal indicating your new address, new school or occupation if you are leaving. You will be given a leavers form from the school administration office. This form should be taken to your teachers and Deputy Principal for completion. You must return all textbooks, library books, school equipment, bus passes and pay any outstanding fees.

How do I make a payment and/or attend an excursion?

Payments can be made through the online “Parent Online Payment” system (accessible from the school’s website – click on “Communities – “Make a payment”). You could also make payments at the school administration office. Payment and note must be submitted by the due date. Students may make payments before school, recess or lunch in the school administration office. EFTPOS and credit card facilities are also available. *Any student causing concern in the school may not be allowed to attend excursions. Misbehaviour whilst on an excursion will be dealt with severely. It may prevent you attending excursions in the future and/or result in the loss of other school privileges.*

 **Make a payment**



If you have lost personal property

All clothing and equipment should be marked with indelible ink to show the owner’s name and roll class. Money, watches and wallets should not be left in clothing or school bags, at PE or sport. Care for valuables is the student’s responsibility. Valuables should not be left unattended at any time. Students are not to bring electronic games, IPODs and mobile phones to school. These will be confiscated and parents notified. Lost property is handed in at the school administration office or the lost property area (near room 9)

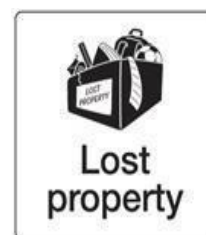

I have lost my timetable.

Please see your Deputy to obtain a reprint (\$1 charge for reprint).

Is there a used uniform shop?

Pre-loved school uniform clothing is available for purchase. Please see the school administration office for more information and purchase.

What if you need to contact your parents?

See a Deputy Principal – mobile phones should not be used.



If you wish to purchase from the canteen before school, during recess and lunch

Pushing in or asking others to buy your food is unacceptable behaviour. Stay in line, moving up to the window when it’s your turn. Only buy for yourself. Students are not to use the canteen between periods or during lesson time. Lunch order can be made before school or at recess.

If you change address or details

It is vital that we have accurate up to date information on all students, particularly in emergency situations. If a change occurs throughout the year, contact the school immediately. Any change of address, phone number or other essential information should be supplied to the school administration office in writing or email to the school’s email address bossleypk-h.school@det.nsw.edu.au – clearly stating your child’s name and class

Saturday School

Enrol Now!

Available to all High School Students
(Government and Non-Government Schools)



**The Saturday School
of
Community Languages**



Free, Board of Studies Accredited Courses Year 7 to HSC
Qualified Teachers – Approved by DEC

Bengali Hindi Khmer Polish
Serbian Spanish (to Extension level)

<http://www.sscl.schools.nsw.edu.au>



Liverpool Girls' High School Centre
Forbes Street, Liverpool. Ph/Fax 9822 5423 (Saturdays)



Enquiries during the week: 9244 5315

Saturday School of Community Languages

Studying a background community language:

- provides an opportunity to develop high levels of skills in a student's background community language
- improves performance across the curriculum through enhanced literacy skills which are transferable to English
- helps maintain rewarding relationships with parents, grandparents, relatives and other community members
- promotes a sense of cultural identity resulting in heightened self-confidence and self-esteem
- places students in a better position to take advantage of employment opportunities

Developing students' knowledge and skills in their background language

www.sscl.schools.nsw.edu.au

Contact your local centre on 9822 5423